

# RECORD DRAWING, WATER SYSTEM (PRIVATE)

WATER STRUCTURES COORDINATES		
GEORGIA COORDINATE SYSTEM, EAST ZONE - NAD 83		
STRUCTURE	NORTHING	EASTING
FCP-1	430559.6	869517.0
FCP-2	430563.4	869513.6
FH-1	430567.0	869864.2
FH-2	430378.7	869875.7
FH-3	430556.1	869524.2
WM-1	430747.1	869637.8
WM-2	430411.8	869894.6
WM-1	430386.7	869846.5
WM-2	430417.5	869851.5
WM-3	430572.6	869578.9
WM-4	430580.1	869574.6
WM-5	430584.1	869581.9
WM-6	430743.5	869618.6
WM-7	430539.3	869862.0
WM-8	430071.0	869138.0
WM-9	430565.5	869574.5

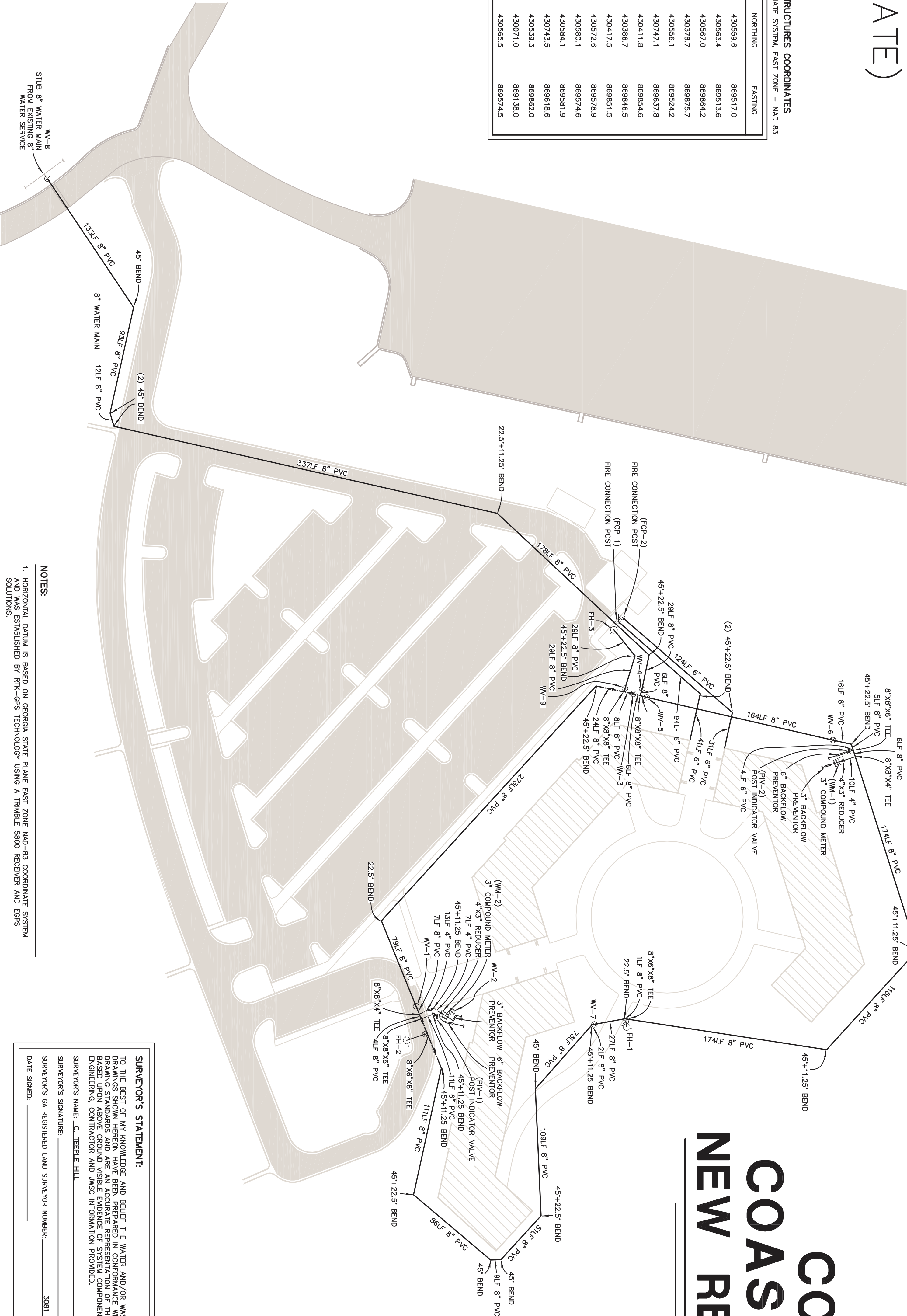

## COLLEGE OF COASTAL GEORGIA NEW RESIDENCE HALLS

SEE NOTE 1.



### ENGINEER'S STATEMENT:

THESE RECORD DRAWINGS HAVE BEEN PREPARED BASED ON CONSTRUCTION, LOCATION, THE EXISTING AND PROPOSED WATER SYSTEMS, AND THE BEST OF HIS/HER KNOWLEDGE, AND BELIEF THESE RECORD DRAWINGS ARE APPROVED MODIFICATIONS OR CHANGES.

ENGINEER'S NAME: \_\_\_\_\_

ENGINEER'S SIGNATURE: \_\_\_\_\_

GA PROFESSIONAL ENGINEER REGISTRATION NUMBER: \_\_\_\_\_

DATE SIGNED: \_\_\_\_\_

### CONTRACTOR'S STATEMENT:

THE WATER AND/OR WASTEWATER PIPING SYSTEMS, AS SHOWN ON THESE RECORD DRAWINGS, HAVE BEEN CONSTRUCTED IN SUBSTANTIAL COMPLIANCE WITH THE STANDARDS AND SPECIFICATIONS FOR THIS PROJECT AND IN CONSIDERATION OF THE TWO (2) YEAR WARRANTY PERIOD, THE CONTRACTOR HAS REVIEWED THE RECORD DRAWINGS AND MATERIALS SPECIFIED OR WORKMANSHIP STANDARDS REQUIRED HAVE BEEN REVIEWED BY THE ENGINEER AND THE JMSC PRIOR TO INSTALLATION. THIS INFORMATION HAS BEEN REVIEWED BY A PRINCIPAL OF THE COMPANY OR AN EXECUTIVE OFFICER, AS CITED BELOW, AND TO THE BEST OF HIS/HER KNOWLEDGE AND BELIEF THESE RECORD DRAWINGS ARE ACCURATE AND COMPLETE.

COMPANY NAME: \_\_\_\_\_

PRINCIPAL/OFFICER'S NAME: \_\_\_\_\_

PRINCIPAL/OFFICER'S SIGNATURE: \_\_\_\_\_

DATE SIGNED: \_\_\_\_\_

### JMSC'S STATEMENT:

THESE RECORD DRAWINGS HAVE BEEN PREPARED AND COMPARED BASED ON PERSONAL FIELD OBSERVATIONS DURING CONSTRUCTION, FIELD TESTING, CITY AND PHYSICAL INSPECTIONS OF SYSTEM COMPONENTS BY JMSC STAFF. THIS INFORMATION HAS BEEN REVIEWED BY JMSC BEST OF THEIR KNOWLEDGE AND BELIEF THESE RECORD DRAWINGS ARE ACCURATE AND COMPLETE IN ACCORDANCE WITH ADOPTED JMSC RECORD DRAWING STANDARDS AND SPECIFICATIONS.

WATER DISTRIBUTION SUPERINTENDENT'S NAME: \_\_\_\_\_

WATER DISTRIBUTION SUPERINTENDENT'S SIGNATURE: \_\_\_\_\_

DATE SIGNED: \_\_\_\_\_

WASTEWATER COLLECTION SUPERINTENDENT'S NAME: \_\_\_\_\_

WASTEWATER COLLECTION SUPERINTENDENT'S SIGNATURE: \_\_\_\_\_

DATE SIGNED: \_\_\_\_\_

PROJECT INSPECTOR'S NAME: \_\_\_\_\_

PROJECT INSPECTOR'S SIGNATURE: \_\_\_\_\_

DATE SIGNED: \_\_\_\_\_

### SURVEYOR'S STATEMENT:

TO THE BEST OF MY KNOWLEDGE AND BELIEF THE WATER AND/OR WASTEWATER RECORD DRAWINGS SHOWN HEREON HAVE BEEN PREPARED IN CONFORMANCE WITH THE JMSC RECORD DRAWING STANDARDS AND ARE AN ACCURATE REPRESENTATION OF THE FIELD CONDITIONS EXISTING AND OBSERVED BY ME OR UNDER MY CLOSE PERSONAL SUPERVISION AND THE ENGINEERING, CONTRACTOR AND JMSC INFORMATION PROVIDED.

SURVEYOR'S NAME: C. JERRE E. HILL

SURVEYOR'S SIGNATURE: \_\_\_\_\_

SURVEYOR'S GA REGISTERED LAND SURVEYOR NUMBER: 3081

DATE SIGNED: \_\_\_\_\_

### SURVEY FOR:

#### H.J. RUSSELL & COMPANY

RECORD DRAWINGS OF: CCGA NEW RESIDENCE HALLS

G.M.D. 26, CITY OF BRUNSWICK, CLYNN COUNTY, GEORGIA

DATE: 4/27/11	DRAWN BY: RNS JR.	SCALE: 1" = 50'	JOB #
EQUIPMENT USED: FIELD CLOSURE: MINIMUM 1 IN 10,000'	PLAT CLOSURE: N/A		10121
TOPCON GTS 303			

#### SHUPE SURVEYING COMPANY, P.C.

3637 DARTON HWY.  
BRUNSWICK, GEORGIA 31525  
912-285-0862



SCALE IN FEET

### LEGEND:

	ASPHALT	VALVE	WM-3	WATER VALVE
	CONCRETE	HYDRANT	FH-1	FIRE HYDRANT
			NUMBER	NUMBER

1. HORIZONTAL DATUM IS BASED ON GEORGIA STATE PLANE EAST ZONE NAD-83 COORDINATE SYSTEM SOLUTIONS.
2. VERTICAL DATUM IS BASED IN MVD-88 AND WAS ESTABLISHED BY RTK-GPS TECHNOLOGY USING A TRIMBLE 5800 RECEIVER AND EPGS SOLUTIONS.
3. WATER AND FORCE MAIN LOCATIONS TAKEN FROM CONTRACTOR MARKUPS AND FIELD LOCATIONS OF ABOVE GROUND READABLE WATER STRUCTURES. SANITARY SEWER GRAVITY LINES, STORM DRAINAGE, AND ROADS TAKEN FROM FIELD LOCATIONS.
4. BUILDINGS AND SIDEWALKS WERE TAKEN FROM CONSTRUCTION PLANS AND ARE FOR ILLUSTRATION PURPOSES ONLY.
5. THE PARCEL IDENTIFICATION NUMBER FOR THIS TRACT IS 01-0631.
6. CONTRACTOR: J. HERS COMPANY, INC.  
1978 HATCH PKWY. S  
BRUNSWICK, GA 31525  
(912) 367-7861

THIS DOCUMENT ORIGINALLY PREPARED AND  
SEAL OF P.C. SURVEYING COMPANY, INC. IS  
CONSIDERED A CONTROLLED DOCUMENT