

# RECORD DRAWING, SANITARY SEWER (PRIVATE)

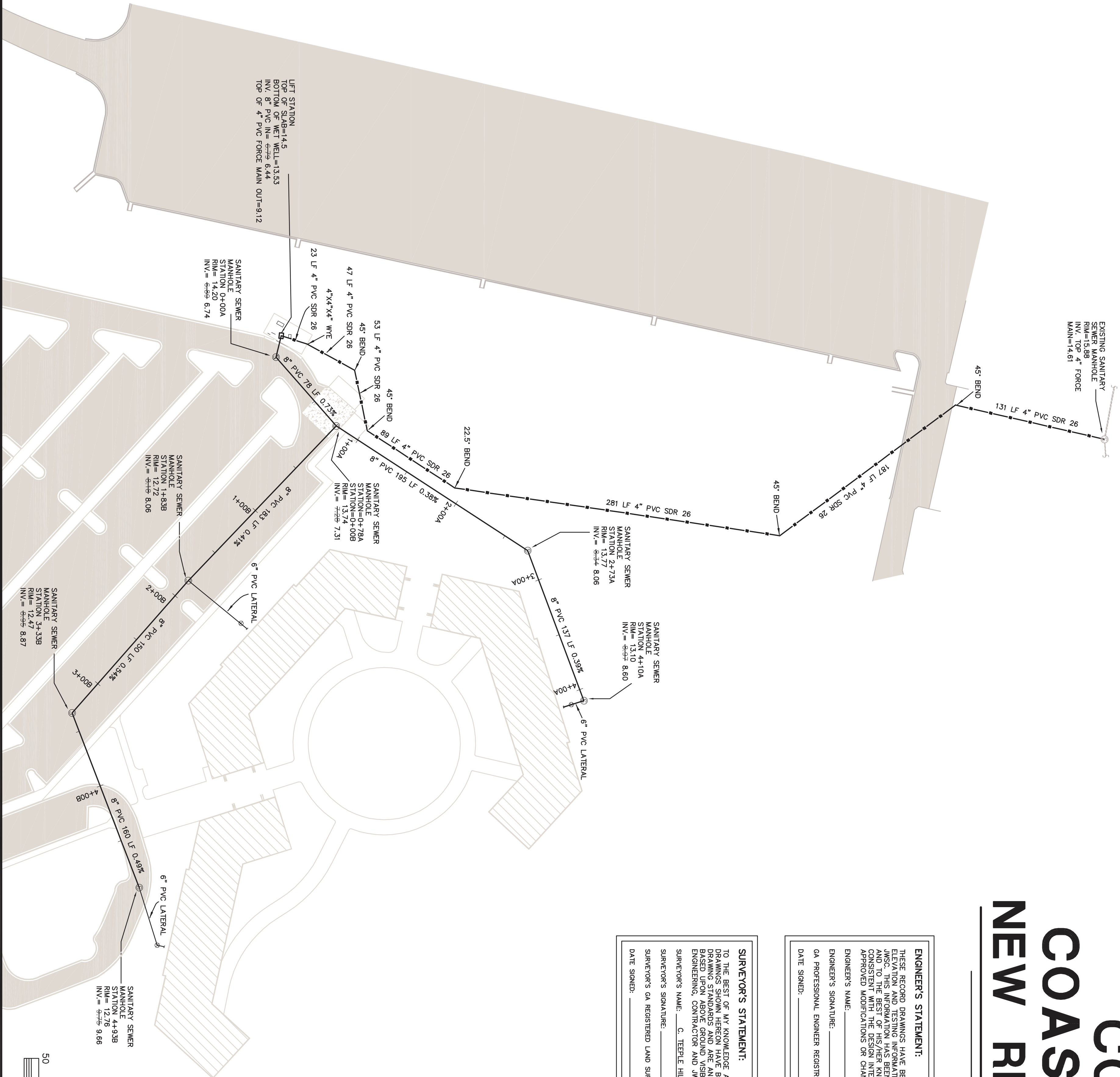

## COLLEGE OF COASTAL GEORGIA NEW RESIDENCE HALLS

SEE NOTE 1.

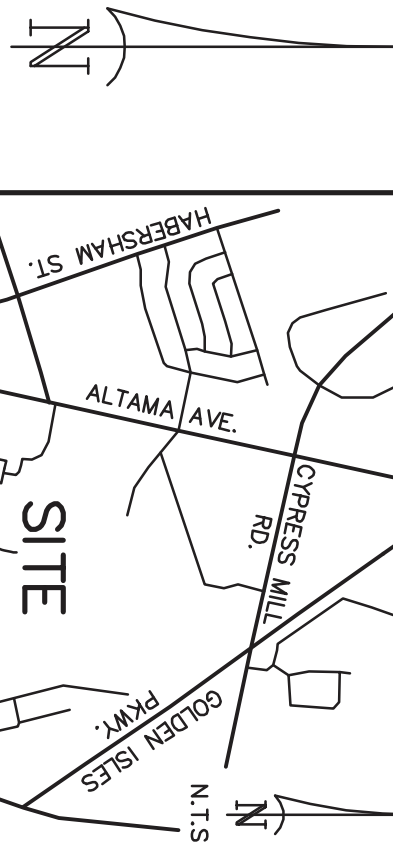

### ENGINEER'S STATEMENT:

THESE RECORD DRAWINGS HAVE BEEN PREPARED BASED ON CONSTRUCTION, LOCATION, ELEVATION AND TESTING INFORMATION PROVIDED BY THE CONTRACTOR, SURVEYOR AND THE DESIGN PROFESSIONAL. THE ENGINEER HAS REVIEWED THE DRAWINGS AND FOUND THEM TO BE CONSISTENT WITH THE DESIGN INTENT OF THE APPROVED SITE DEVELOPMENT PLANS AND ANY APPROVED MODIFICATIONS OR CHANGES.

ENGINEER'S NAME: \_\_\_\_\_

GA PROFESSIONAL ENGINEER REGISTRATION NUMBER: \_\_\_\_\_

DATE SIGNED: \_\_\_\_\_

### SURVEYOR'S STATEMENT:

TO THE BEST OF MY KNOWLEDGE AND BELIEF THE WATER AND/OR WASTEWATER RECORD DRAWINGS SHOWN HEREON HAVE BEEN PREPARED IN CONFORMANCE WITH THE JWC RECORD DRAWING STANDARDS AND THE SURVEYOR'S PRACTICE. THESE RECORD DRAWINGS ARE BASED UPON ABOVE GROUND VISIBLE EVIDENCE OF SYSTEM COMPONENTS, AND THE ENGINEERING, CONTRACTOR AND JWC INFORMATION PROVIDED.

SURVEYOR'S NAME: C. TEEPLE HILL

SURVEYOR'S SIGNATURE: \_\_\_\_\_

SURVEYOR'S GA REGISTERED LAND SURVEYOR NUMBER: 3081

DATE SIGNED: \_\_\_\_\_

### CONTRACTOR'S STATEMENT:

THE WATER AND/OR WASTEWATER PIPING SYSTEMS, AS SHOWN ON THESE RECORD DRAWINGS, HAVE BEEN CONSTRUCTED IN SUBSTANTIAL COMPLIANCE WITH THE STANDARDS AND SPECIFICATIONS OF THE DESIGN PROFESSIONAL. THE CONTRACTOR HAS REVIEWED THE DRAWINGS AND FOUND THEM TO BE CONSISTENT WITH THE DESIGN INTENT OF THE APPROVED SITE DEVELOPMENT PLANS AND ANY APPROVED MODIFICATIONS OR CHANGES.

COMPANY NAME: \_\_\_\_\_

PRINCIPAL/OFFICER'S NAME: \_\_\_\_\_

PRINCIPAL/OFFICER'S SIGNATURE: \_\_\_\_\_

DATE SIGNED: \_\_\_\_\_

### JWC'S STATEMENT:

THESE RECORD DRAWINGS HAVE BEEN PREPARED AND CONFIRMED BASED ON PERIODIC FIELD OBSERVATIONS DURING CONSTRUCTION, FIELD TESTING, CCTV AND PHYSICAL INSPECTIONS OF THE SYSTEMS. THE JWC HAS REVIEWED THE DRAWINGS AND FOUND THEM TO BE CONSISTENT WITH THE DESIGN INTENT OF THE APPROVED SITE DEVELOPMENT PLANS AND ANY APPROVED MODIFICATIONS OR CHANGES.

WATER DISTRIBUTION SUPERINTENDENT'S NAME: \_\_\_\_\_

WATER DISTRIBUTION SUPERINTENDENT'S SIGNATURE: \_\_\_\_\_

DATE SIGNED: \_\_\_\_\_

WASTEWATER COLLECTION SUPERINTENDENT'S NAME: \_\_\_\_\_

WASTEWATER COLLECTION SUPERINTENDENT'S SIGNATURE: \_\_\_\_\_

DATE SIGNED: \_\_\_\_\_

PROJECT INSPECTOR'S NAME: \_\_\_\_\_

PROJECT INSPECTOR'S NAME SIGNATURE: \_\_\_\_\_

DATE SIGNED: \_\_\_\_\_

### NOTES:

- HORIZONTAL DATUM IS BASED ON GEORGIA STATE PLANE EAST ZONE NAD-83 COORDINATE SYSTEM AND WAS ESTABLISHED BY RTK-GPS TECHNOLOGY USING A TRIMBLE 5600 RECEIVER AND EPPS SOLUTIONS.
- VERTICAL DATUM IS BASED IN MVD-88 AND WAS ESTABLISHED BY RTK-GPS TECHNOLOGY USING A TRIMBLE 5600 RECEIVER AND EPPS SOLUTIONS.
- WATER AND FORCE MAIN LOCATIONS TAKEN FROM CONTRACTOR MARKERS AND FIELD LOCATIONS OF ABOVE GROUND READABLY VISIBLE STRUCTURES. SANITARY SEWER GRANTY LINES, STORM DRAINAGE, AND ROADS TAKEN FROM FIELD LOCATIONS.
- BUILDINGS AND SIDEWALKS WERE TAKEN FROM CONSTRUCTION PLANS AND ARE FOR ILLUSTRATION PURPOSES ONLY.
- THE PARCEL IDENTIFICATION NUMBER FOR THIS TRACT IS 01-06131.
- CONTRACTOR: J. HERS COMPANY, INC.  
1505 BRUNSWICK HWY. S  
BRUNSWICK, GEORGIA  
(912) 357-7881

### LEGEND:

- ⑤ SANITARY SEWER MANHOLE      ⊗ CLEAN-OUT
- ASPHALT      ■ CONCRETE

### SURVEY FOR:

#### H.J. RUSSELL & COMPANY

RECORD DRAWINGS OF: COGA NEW RESIDENCE HALLS

G.M.D. 26, CITY OF BRUNSWICK, CLYNN COUNTY, GEORGIA

DATE: 4/27/11 DRAWN BY: RNS JR. SCALE: 1"= 50'

EQUIPMENT USED: FIELD CLOSURE: PLAT CLOSURE: JOB #

TOPCON GTS 303 MINIMUM 1 IN 10,000' N/A 10121

#### SHUPE SURVEYING COMPANY, P.C.

3637 DARTEN HWY.  
BRUNSWICK, GEORGIA 31525  
912-265-0862 10121-1.DWG



THIS DOCUMENT ORIGINALLY ISSUED AND SEALED BY REFLECTED IN THE SEAL. IT IS NOT TO BE REPRODUCED OR COPIED WITHOUT THE WRITTEN CONSENT OF THE SURVEYOR.