

# **APPENDIX E**

## **REGULATORY RECORDS DOCUMENTATION**

# ***FirstSearch Technology Corporation***

## **Environmental FirstSearch<sup>TM</sup> Report**

**TARGET PROPERTY:**

**12202 APACHE AVE**

**SAVANNAH GA 31419**

**Job Number: 03-0527.30**

**PREPARED FOR:**

**EMC Engineering Services, Inc.**

**23 East Charlton Street/P.O.Box 8101**

**Savannah, Georgia 31412**

**[www.emc-eng.com](http://www.emc-eng.com)**

**Environmetal/Marine/Civil**

**10-13-03**



***Tel: (407) 265-8900***

***Fax: (407) 265-8904***

# Environmental FirstSearch Search Summary Report

**Target Site:** 12202 APACHE AVE  
SAVANNAH GA 31419

## FirstSearch Summary

Database	Sel	Updated	Radius	Site	1/8	1/4	1/2	1/2>	ZIP	TOTALS
NPL	Y	09-09-03	1.00	0	0	0	0	0	0	0
CERCLIS	Y	06-09-03	0.50	0	0	0	0	-	1	1
NFRAP	Y	06-09-03	0.25	0	0	0	-	-	0	0
RCRA TSD	Y	07-08-03	0.50	0	0	0	0	-	0	0
RCRA COR	Y	07-08-03	1.00	0	0	0	0	0	0	0
RCRA GEN	Y	07-08-03	0.25	0	0	0	-	-	1	1
RCRA NLR	N	07-08-03	0.25	-	-	-	-	-	-	-
ERNS	Y	12-31-02	0.25	0	0	0	-	-	23	23
NPDES	N	08-18-03	0.25	-	-	-	-	-	-	-
FINDS	N	07-16-98	0.25	-	-	-	-	-	-	-
TRIS	N	03-07-03	0.25	-	-	-	-	-	-	-
State Sites	Y	07-01-02	1.00	0	0	0	0	0	0	0
Spills-1990	Y	08-06-03	0.25	0	0	0	-	-	251	251
Spills-1980	N	NA	0.15	-	-	-	-	-	-	-
SWL	Y	08-01-02	0.50	0	0	0	0	-	5	5
Permits	N	NA	0.25	-	-	-	-	-	-	-
Other	Y	07-27-01	0.25	0	0	0	-	-	2	2
REG UST/AST	Y	04-11-01	0.25	1	1	0	-	-	2	4
Leaking UST	Y	03-01-03	0.50	1	0	0	3	-	0	4
State Wells	N	11-14-96	0.50	-	-	-	-	-	-	-
Aquifers	N	NA	0.50	-	-	-	-	-	-	-
ACEC	N	NA	0.50	-	-	-	-	-	-	-
Wetlands	N	11-20-00	0.50	-	-	-	-	-	-	-
Floodplains	N	05-01-96	0.50	-	-	-	-	-	-	-
Nuclear Permits	N	04-30-99	0.50	-	-	-	-	-	-	-
Historic/Landmark	N	09-01-02	0.50	-	-	-	-	-	-	-
Federal Land Use	N	06-17-98	0.50	-	-	-	-	-	-	-
Federal Wells	N	NA	0.50	-	-	-	-	-	-	-
Releases(Air/Water)	N	12-31-01	0.25	-	-	-	-	-	-	-
HMIRS	N	05-24-02	0.25	-	-	-	-	-	-	-
NCDB	N	03-28-02	0.25	-	-	-	-	-	-	-
PADS	N	07-23-03	0.25	-	-	-	-	-	-	-
Federal Other	N	NA	0.25	-	-	-	-	-	-	-
Misc	N	NA	0.25	-	-	-	-	-	-	-
Towers	N	08-16-01	0.25	-	-	-	-	-	-	-
Soils	N	03-18-97	0.25	-	-	-	-	-	-	-
Receptors	N	01-01-95	0.50	-	-	-	-	-	-	-
- TOTALS -				2	1	0	3	0	285	291

### Notice of Disclaimer

Due to the limitations, constraints, inaccuracies and incompleteness of government information and computer mapping data currently available to FirstSearch Technology Corp., certain conventions have been utilized in preparing the locations of all federal, state and local agency sites residing in FirstSearch Technology Corp.'s databases. All EPA NPL and state landfill sites are depicted by a rectangle approximating their location and size. The boundaries of the rectangles represent the eastern and western most longitudes; the northern and southern most latitudes. As such, the mapped areas may exceed the actual areas and do not represent the actual boundaries of these properties. All other sites are depicted by a point representing their approximate address location and make no attempt to represent the actual areas of the associated property. Actual boundaries and locations of individual properties can be found in the files residing at the agency responsible for such information.

### Waiver of Liability

Although FirstSearch Technology Corp. uses its best efforts to research the actual location of each site, FirstSearch Technology Corp. does not and can not warrant the accuracy of these sites with regard to exact location and size. All authorized users of FirstSearch Technology Corp.'s services proceeding are signifying an understanding of FirstSearch Technology Corp.'s searching and mapping conventions, and agree to waive any and all liability claims associated with search and map results showing incomplete and or inaccurate site locations.

***Environmental FirstSearch  
Site Information Report***

**Request Date:** 10-13-03  
**Requestor Name:** J. David Ross  
**Standard:** ASTM

**Search Type:** COORD  
**Job Number:** 03-0527.30

**TARGET ADDRESS:** 12202 APACHE AVE  
SAVANNAH GA 31419

*Demographics*

<b>Sites:</b> 291	<b>Non-Geocoded:</b> 285	<b>Population:</b> NA
<b>Radon:</b> 0.7 - 2.2 PCI/L		

*Site Location*

	<u>Degrees (Decimal)</u>	<u>Degrees (Min/Sec)</u>		<u>UTMs</u>
<b>Longitude:</b>	-81.169377	-81:10:10	<b>Easting:</b>	483997.727
<b>Latitude:</b>	31.980652	31:58:50	<b>Northing:</b>	3538116.088
			<b>Zone:</b>	17

*Comment*

**Comment:**PHASE I ESA

*Additional Requests/Services*

**Adjacent ZIP Codes:** 0 Mile(s)

**Services:**

<u>ZIP</u>				
<u>Code</u>	<u>City Name</u>	<u>ST</u>	<u>Dist/Dir</u>	<u>Sel</u>

	<u>Requested?</u>	<u>Date</u>
Sanborns	No	
Aerial Photographs	No	
Topographical Maps	No	
City Directories	No	
Title Search	No	
Municipal Reports	No	
Online Topos	No	

# *Environmental FirstSearch*

## *Sites Summary Report*

**TARGET SITE:** 12202 APACHE AVE  
SAVANNAH GA 31419

**JOB:** 03-0527.30  
PHASE I ESA

**TOTAL:** 291      **GEOCODED:** 6      **NON GEOCODED:** 285      **SELECTED:** 0

ID	DB Type	Site Name/ID/Status	Address	Dist/Dir	Map ID
25	ERNS	496724/RAILROAD	GEORGIA PORT AUTH. SAVANNAH GA	NON GC	
31	ERNS	557159/FIXED FACILITY	GEORGIA PORT AUTHORITY GARDEN SAVANNAH GA	NON GC	
30	ERNS	376682/UNKNOWN	BERTH 62 GARDEN CITY TERMINAL SAVANNAH GA 31419	NON GC	
29	ERNS	NRC-624104/MOBILE	ABERCORN ST SAVANNAH GA	NON GC	
28	ERNS	NRC-552225/MOBILE	I-95 EXIT 14 SAVANNAH GA	NON GC	
27	ERNS	566512/UNKNOWN	BERTH 12 OCEAN TERMINAL SAVANNAH GA 31419	NON GC	
26	ERNS	376681/UNKNOWN	BERTH 62 OF THE GARDEN CITY TE SAVANNAH GA 31419	NON GC	
277	SPILLS	GASP-0402-0017160	A & E PALLETS (ON A REGULAR BA SAVANNAH GA	NON GC	
279	SPILLS	GASP-0402-0018396	1401 WILLIS DRIVE SAVANNAH GA 31419	NON GC	
280	SPILLS	GASP-0803-0000351	SAVANNAH RIVER NEAR HYATT HOTE SAVANNAH GA	NON GC	
281	SPILLS	GASP-0803-0000357	NEAR CITGO RIVERFRONTAGE SAVANNAH GA	NON GC	
282	SPILLS	GASP-0503-0000207	OCEAN TERMINAL-BERTH 16 SAVANNAH GA	NON GC	
278	SPILLS	GASP-0303-0002720	A LAGOON ON SKIDAWAY ISLAND TH SAVANNAH GA	NON GC	
32	SPILLS	???? GASP-0402-0009425	KINGS PORT TURNING BASE, DAYBO SAVANNAH GA	NON GC	
290	UST	1ST STOP FOOD STORE #1 4250218	GA HWY 204/RT 4 BOX 451B^ SAVANNAH GA 31419	NON GC	
33	SPILLS	A H PALLET COMPANY GASP-0402-0006768	ACROSS FROM CALLER S HOME SAVANNAH GA	NON GC	
34	SPILLS	A.G.SASSER GASP-0402-0008788	DEPTFORD TRACT SAVANNAH GA	NON GC	
35	SPILLS	ANGEL OAKS DEVELOPER GASP-0402-0010641	ANGEL OAKS S/D ON WILMINGTON I SAVANNAH GA	NON GC	
36	SPILLS	ARCADIAN GASP-0402-0017452	HWY 25 NORTH OF THE PORT AUTHO SAVANNAH GA	NON GC	
38	SPILLS	ARCADIAN CORPORATION GASP-0402-0007962	PORT WENTWORTH SAVANNAH GA	NON GC	

***Environmental FirstSearch  
Sites Summary Report***

**TARGET SITE:** 12202 APACHE AVE  
SAVANNAH GA 31419

**JOB:** 03-0527.30  
PHASE I ESA

**TOTAL:** 291      **GEOCODED:** 6      **NON GEOCODED:** 285      **SELECTED:** 0

ID	DB Type	Site Name/ID/Status	Address	Dist/Dir	Map ID
1	UST	ENMARK ABERCORN #010 4250431	14000 ABERCORN ST SAVANNAH GA 31419	0.00 --	3
5	LUST	ENMARK ABERCORN #010 4250431	14000 ABERCORN ST SAVANNAH GA 31419	0.00 --	3
2	UST	SHELL #19 9025219	14001 ABERCORN STREET SAVANNAH GA 31419	0.02 NE	5
3	LUST	57 & 58 FOREST RIVER LOTS 9025305	1132 & 1134 SHAWNEE AVENUE SAVANNAH GA 31419	0.34 NW	2
4	LUST	BST/R2202/SVNHGAMG/BELL SOUTH 9000274	12032 MIDDLEGROUND RD SAVANNAH GA 31419	0.40 NE	1
6	LUST	SAVANNAH MALL 9000356	RIO RD & ABERCORN ST EXT SAVANNAH GA 31419	0.49 NW	4

# Environmental FirstSearch

## Sites Summary Report

**TARGET SITE:** 12202 APACHE AVE  
SAVANNAH GA 31419

**JOB:** 03-0527.30  
PHASE I ESA

**TOTAL:** 291      **GEOCODED:** 6      **NON GEOCODED:** 285      **SELECTED:** 0

ID	DB Type	Site Name/ID/Status	Address	Dist/Dir	Map ID
37	SPILLS	ARCADIAN CORPORATION GASP-0402-0000059	PORT WENTWORTH SAVANNAH GA	NON GC	
39	SPILLS	ASX TRANSPORTATION GASP-0402-0007650	SAVANNAH RAILYARD SAVANNAH GA	NON GC	
40	SPILLS	ATLANTIC WOOD INDUSTRIES GASP-1002-0000196	SAVANNAH GA	NON GC	
41	SPILLS	B WRIGHT TRANSPORT GASP-0402-0023489	ROBERT D MILLER RD & ST RT 307 SAVANNAH GA	NON GC	
42	SPILLS	BAKENGCRACHT (BOAT) GASP-0402-0017261	GEORGIA PACIFIC DOCK SAVANNAH GA	NON GC	
43	SPILLS	BELLS LANDING GASP-0402-0020909	BEHIND BAR ON APACHE AVE SAVANNAH GA 31419	NON GC	
44	SPILLS	BELLS LANDING GASP-0303-0001635	BEHIND BAR ON APACHE AVE SAVANNAH GA 31419	NON GC	
45	SPILLS	BILL CULLMAN GASP-1002-0000290	SKIDAWAY RIVER AT GREEN MARKER SAVANNAH GA	NON GC	
46	SPILLS	BING TRUCKING CO. GASP-1002-0000259	I-516 1 MILE WEST OF MONTGOMER SAVANNAH GA	NON GC	
8	RCRAGN	BP OIL SITE #24122 GAD984298695/VGN	RT 4 BOX 441-J SAVANNAH GA 31419	NON GC	
47	SPILLS	BUDDY GUMBO S RESTAURANT GASP-0402-0015885	BUDDY GUMBO S RESTAURANT SAVANNAH GA	NON GC	
48	SPILLS	BUILDERS TRANSPORT GASP-0402-0017680	HWY 17 1.5 MILES NORTH OF HWY SAVANNAH GA	NON GC	
9	ERNS	C259 NRC-605983/RAILROAD	SAVANNAH GA	NON GC	
283	SWL	CARTER-QUACCO RD (L) 025-063D	SS QUACCO RD .5 MI W US 17 SAVANNAH GA 31419	NON GC	
49	SPILLS	CECELIA TRANE GASP-0402-0011799	RIVERWATCH MARINA SAVANNAH GA	NON GC	
50	SPILLS	CENTRAL INDUSTRIES GASP-0303-0002911	BULL RIVER MARINE OFF OF HWY 8 SAVANNAH GA	NON GC	
51	SPILLS	CHARLES MCALEER GASP-0402-0015577	WASSAW SOUND AT BOUY # 10 SAVANNAH GA	NON GC	
52	SPILLS	CHARLES WILLIAM LYNCH GASP-0803-0000480	OFF HIGHWAY 17 AT COTTON BALEN SAVANNAH GA	NON GC	
284	SWL	CHATHAM CO-SR 367 WILMINGTON IS PH 025-058D	S S SR 367, N END WLMNGTN IS SAVANNAH GA 31410	NON GC	
53	SPILLS	CHEM WATER GASP-0402-0015714	GEORGIA PORTS AUTHORITY SAVANNAH GA	NON GC	

# Environmental FirstSearch

## Sites Summary Report

**TARGET SITE:** 12202 APACHE AVE  
SAVANNAH GA 31419

**JOB:** 03-0527.30  
PHASE I ESA

**TOTAL:** 291      **GEOCODED:** 6      **NON GEOCODED:** 285      **SELECTED:** 0

ID	DB Type	Site Name/ID/Status	Address	Dist/Dir	Map ID
54	SPILLS	CHEMICAL RELEASE GASP-0402-0012828	RAIL YARD SAVANNAH GA	NON GC	
55	SPILLS	CHEMICAL RELEASE GASP-0402-0015347	KENSEY AVENUE-GORDONTON S/S SAVANNAH GA	NON GC	
56	SPILLS	CIRCLE SUPPLY GASP-0402-0008969	HWY 44 SPAR OFF HWY 25 CONNECT SAVANNAH GA	NON GC	
65	SPILLS	CITY OF SAVANNAH GASP-0402-0015573	BACON PARK LIFTSTATION NEAR GO SAVANNAH GA	NON GC	
60	SPILLS	CITY OF SAVANNAH GASP-0402-0015588	LIFTSTATION 115 SAVANNAH GA	NON GC	
59	SPILLS	CITY OF SAVANNAH GASP-0402-0015487	EISENHOWER WEST OF WATERS LIF SAVANNAH GA	NON GC	
62	SPILLS	CITY OF SAVANNAH GASP-0402-0017316	CELL ST STATION SAVANNAH GA	NON GC	
64	SPILLS	CITY OF SAVANNAH GASP-0402-0015765	FOREST MAIN RD SAVANNAH GA	NON GC	
63	SPILLS	CITY OF SAVANNAH GASP-0402-0016061	GEORGIA TOWN GRACE ATS PAHSE 2 SAVANNAH GA	NON GC	
57	SPILLS	CITY OF SAVANNAH GASP-0402-0002335	LIFT STATION 16 SAVANNAH GA	NON GC	
67	SPILLS	CITY OF SAVANNAH GASP-0402-0019076	STATION 3 OFF QUAIL FOREST DRI SAVANNAH GA 31419	NON GC	
66	SPILLS	CITY OF SAVANNAH GASP-0402-0016078	LARGO DR PLANT SAVANNAH GA 31419	NON GC	
58	SPILLS	CITY OF SAVANNAH GASP-0402-0009216	OFF SYCAMORE IN A FIELD SAVANNAH GA	NON GC	
61	SPILLS	CITY OF SAVANNAH GASP-0402-0015928	WILMINGTON ISLAND SAVANNAH GA	NON GC	
68	SPILLS	COLONIAL TERMINALS GASP-0803-0000562	SAVANNAH GA	NON GC	
70	SPILLS	CONSOLIDATED TANK LINES GASP-0402-0007331	FROM EAST PRESIDENT S STREET T SAVANNAH GA	NON GC	
69	SPILLS	CONSOLIDATED TANK LINES GASP-0402-0006937	FROM EAST PRESIDENT S STREET T SAVANNAH GA	NON GC	
71	SPILLS	CONTAINER BERTH 7 GASP-0402-0022495	CONTAINER BERTH 7 SAVANNAH GA	NON GC	
72	SPILLS	CRESCENT TOWING GASP-0803-0000461	COLONIAL #3 SAVANNAH GA	NON GC	
285	SWL	CROSBY-QUACCO RD (L) 025-068D	SS QUACCO RD, .5 MI W US 17 SAVANNAH GA 31419	NON GC	



# Environmental FirstSearch

## Sites Summary Report

**TARGET SITE:** 12202 APACHE AVE  
SAVANNAH GA 31419

**JOB:** 03-0527.30  
PHASE I ESA

**TOTAL:** 291      **GEOCODED:** 6      **NON GEOCODED:** 285      **SELECTED:** 0

ID	DB Type	Site Name/ID/Status	Address	Dist/Dir	Map ID
73	SPILLS	CSX RAILROAD GASP-0402-0023408	CSX RAILROAD SAVANNAH GA	NON GC	
74	SPILLS	DANN OCEAN TOWING GASP-0402-0012224	GENERAL FOODS DOCK SAVANNAH GA	NON GC	
75	SPILLS	DARIUS MAZEIRA GASP-0802-0000108	I-95 BRIDGE BETWEEN GA & SC SAVANNAH GA	NON GC	
76	SPILLS	DEPT OF DEFENSE / MARINE FLARE GASP-0402-0001453	SOUTHERN PART OF WILLIAMSON IS SAVANNAH GA	NON GC	
77	SPILLS	DOLPHIN GASP-0402-0023480	BERTH 1 COLONIAL FUEL SAVANNAH GA 31419	NON GC	
78	SPILLS	DR. PHILLIP OTT GASP-0303-0001582	ON ALLEY BETWEEN WEST GWINNETT SAVANNAH GA	NON GC	
79	SPILLS	DR. PHILLIP OTT GASP-0402-0020853	ON ALLEY BETWEEN WEST GWINNETT SAVANNAH GA	NON GC	
80	SPILLS	DUKE MARINE LABS GASP-0803-0000346	40 MILES S OF SAVANNAH RIVER M SAVANNAH GA	NON GC	
82	SPILLS	DUMPING GASP-0402-0007661	SAVANNAH GA	NON GC	
81	SPILLS	DUMPING GASP-0402-0008011	GROVE PLANT ROAD SAVANNAH GA 31419	NON GC	
83	SPILLS	EASON DIVERS GASP-0402-0010376	BY BOAT-PASS UNDER COFFEE BLUF SAVANNAH GA	NON GC	
286	SWL	EAST COAST TERMINAL COMPANY PBR-025-41TS	1 HARBOR STREET SAVANNAH GA	NON GC	
84	SPILLS	ECM MARITIME GASP-0402-0021664	VOPAK GARDEN CITY TERMINAL,SAV SAVANNAH GA	NON GC	
85	SPILLS	ECM MARITIME GASP-0303-0002396	VOPAK GARDEN CITY TERMINAL,SAV SAVANNAH GA	NON GC	
10	ERNS	ECM-HUDSON MARITIME SVC. 646279/MARINE- RELEASED FRO	ST SERVICES, DOCK #2 SAVANNAH GA	NON GC	
11	ERNS	EDLOW INTERNATIONAL 487597/FIXED FACILITY	GEORGIA PORT AUTHORITY OCEAN T SAVANNAH GA	NON GC	
86	SPILLS	EL PASO CORPORATION GASP-0802-0000485	ELBA ISLAND SAVANNAH GA	NON GC	
87	SPILLS	EXECUTIVE SHIP MANAGEMENT GASP-0402-0020371	VOPAK TERMINALSAVANNAH RIVER SAVANNAH GA	NON GC	
88	SPILLS	EXECUTIVE SHIP MANAGEMENT GASP-0303-0001148	VOPAK TERMINALSAVANNAH RIVER SAVANNAH GA	NON GC	
89	SPILLS	FISH KILL GASP-0402-0009573	PRESIDENT ST BRIDGE SAVANNAH GA	NON GC	

# Environmental FirstSearch

## Sites Summary Report

**TARGET SITE:** 12202 APACHE AVE  
SAVANNAH GA 31419

**JOB:** 03-0527.30  
PHASE I ESA

**TOTAL:** 291      **GEOCODED:** 6      **NON GEOCODED:** 285      **SELECTED:** 0

ID	DB Type	Site Name/ID/Status	Address	Dist/Dir	Map ID
90	SPILLS	FLA. TRUCKING LINES GASP-0402-0006584	IN THE RIVER WHERE THEY ARE BU SAVANNAH GA	NON GC	
91	SPILLS	FRANK BANK GASP-0402-0023139	COFFEE BLUFF MARINA SAVANNAH GA 31419	NON GC	
92	SPILLS	FUEL SPILL GASP-0402-0012990	HWY 240 & I-95 SAVANNAH GA	NON GC	
96	SPILLS	FUEL SPILL GASP-0402-0016120	OCENA TERMINAL SAVANNAH GA	NON GC	
95	SPILLS	FUEL SPILL GASP-0402-0022492	BRUNSWICK CITY DOCKS SAVANNAH GA	NON GC	
93	SPILLS	FUEL SPILL GASP-0402-0018224	BUOY 18 SAVANNAH GA	NON GC	
94	SPILLS	FUEL SPILL GASP-0402-0015931	BRUNSWICK LANDING MARINA SAVANNAH GA	NON GC	
97	SPILLS	GA PORT AUTH GASP-0402-0016271	CONTAINER BERTH 6 - GARDEN CIT SAVANNAH GA	NON GC	
98	SPILLS	GA PORTS AUTH GASP-0402-0010645	COLD STORAGE AREA IN GARDEN CI SAVANNAH GA	NON GC	
99	SPILLS	GEORGIA AIR NATIONAL GUARD GASP-0402-0021995	ABOVE GROUND STORAGE TANK 967 SAVANNAH GA	NON GC	
100	SPILLS	GEORGIA REGIONAL HOSPITAL GASP-0402-0017207	MAYFAIR SUB/DIV SAVANNAH GA	NON GC	
287	SWL	GPA-HUTCHINSON ISLAND (L) 025-067D	HUTCHINSON IS OPP DUNDEE CANAL SAVANNAH GA 31402	NON GC	
101	SPILLS	GREEN RIVER TRANSPORT GASP-0402-0018582	SAVANNAH RIVER AREA SAVANNAH GA 31419	NON GC	
102	SPILLS	GREEN RIVER TRANSPORT GASP-0402-0018594	BERTH 17 OCEAN TERMINAL SAVANNAH GA 31419	NON GC	
103	SPILLS	GREENSVILLE RESPONSE CORPORATION GASP-0402-0009040	GEORGIA PORTS TERMINAL-OCEAN T SAVANNAH GA	NON GC	
104	SPILLS	GROCERY SERVICES GASP-0402-0022505	I-95NB EXIT 99B SAVANNAH GA	NON GC	
105	SPILLS	H AND H BEER SALES GASP-0402-0017255	H AND H BEER SALES SAVANNAH GA	NON GC	
288	OTHER	HARRY S. TRUMAN PARKWAY PHASE III 140/NON-HSI	HARRY S. TRUMAN PARKWAY SAVANNAH GA	NON GC	
106	SPILLS	HATAG LLOYD GASP-0402-0014794	AT PORTS AUTHORITY SAVANNAH GA	NON GC	
107	SPILLS	HEATING OIL SPILL GASP-0402-0008169	76 LEO ROAD SAVANNAH GA	NON GC	

# Environmental FirstSearch

## Sites Summary Report

**TARGET SITE:** 12202 APACHE AVE  
SAVANNAH GA 31419

**JOB:** 03-0527.30  
PHASE I ESA

**TOTAL:** 291      **GEOCODED:** 6      **NON GEOCODED:** 285      **SELECTED:** 0

ID	DB Type	Site Name/ID/Status	Address	Dist/Dir	Map ID
108	SPILLS	HORNADY TRUCK LINE GASP-0402-0014246	I-95 @ EXIT 19 (ENMARK STATION SAVANNAH GA	NON GC	
289	OTHER	HUTCHINSON SITE TWO 131/NON-HSI	HUTCHINSON ISLAND, 1 MILE WEST SAVANNAH GA	NON GC	
109	SPILLS	IMPERIAL SUGAR GASP-1002-0000126	HWY 25 NORTH AT SAVANNAH RIVER SAVANNAH GA	NON GC	
12	ERNS	INTERSTATE 516 / 1 MILE WEST OF MON NRC-625388/MOBILE	SAVANNAH GA	NON GC	
110	SPILLS	J.M. CONTAINER GASP-0402-0007905	GA PORT AUTHORITY SAVANNAH GA	NON GC	
111	SPILLS	JACKIE SOMMERS GASP-0402-0004681	HWY 204 AT SNOWGREEN FARM SAVANNAH GA	NON GC	
112	SPILLS	JIM ZEHNER GASP-0402-0008365	USDA RESEARCH FACILITY SAVANNAH GA	NON GC	
113	SPILLS	JMP PROPERTIES GASP-0802-0000359	SAVANNAH BEND MARINA SAVANNAH GA	NON GC	
114	SPILLS	JOEL MOORE GASP-0402-0012311	CAUSTON BLUFF MARINA SAVANNAH GA	NON GC	
115	SPILLS	JUDY HELMAY GASP-0402-0011551	CHARTER BOAT COMPANY, HOGAN MA SAVANNAH GA	NON GC	
116	SPILLS	KOCH TRUCK LINE INC. GASP-0402-0008377	HWY 307 WESTBOUND AT ROBERT B. SAVANNAH GA	NON GC	
117	SPILLS	L AND J CONSTRUCTION COMPANY GASP-0402-0008393	OFF HWY 17S ON SW BY-PASS SAVANNAH GA	NON GC	
118	SPILLS	LANDFILL FIRE GASP-0402-0015937	CHATHAM CO LANDFILL SAVANNAH GA	NON GC	
119	SPILLS	LARGO TIBET ELEMENTARY GASP-0402-0006737	IN DITCH PARALLEL TO SCHOOL ON SAVANNAH GA	NON GC	
120	SPILLS	LOGIS FLUID SOLUTIONS GASP-0402-0021050	SAVANNAH GA	NON GC	
121	SPILLS	LOGIS FLUID SOLUTIONS GASP-0303-0001777	SAVANNAH GA	NON GC	
122	SPILLS	LOXGREEN CO INC GASP-0402-0022746	I 95 NB AT MIKE MARKER 106 NEA SAVANNAH GA	NON GC	
123	SPILLS	M/V SEALAND VOYAGEUR GASP-0402-0019610	GARDEN CITY TERMINAL BERTH 7 SAVANNAH GA	NON GC	
124	SPILLS	M/V SEALAND VOYAGEUR GASP-0303-0000344	GARDEN CITY TERMINAL BERTH 7 SAVANNAH GA	NON GC	
125	SPILLS	MARINE VESSEL SNOWBIRD GASP-0402-0017920	EAST COAST TERMINAL - MARINE V SAVANNAH GA	NON GC	

# Environmental FirstSearch

## Sites Summary Report

**TARGET SITE:** 12202 APACHE AVE  
SAVANNAH GA 31419

**JOB:** 03-0527.30  
PHASE I ESA

**TOTAL:** 291      **GEOCODED:** 6      **NON GEOCODED:** 285      **SELECTED:** 0

ID	DB Type	Site Name/ID/Status	Address	Dist/Dir	Map ID
126	SPILLS	MARINE VESSELS COLLIDED SAVANNAH RI GASP-0402-0018555	SAVANNAH HARBOR SAVANNAH GA	NON GC	
127	SPILLS	MAYFIELD & SONS TRUCKING GASP-0402-0010974	-- SAVANNAH GA	NON GC	
128	SPILLS	MCKENZIE TANK LINES GASP-0402-0009412	STATE ROUTE 351 & STATE ROUTE SAVANNAH GA	NON GC	
129	SPILLS	MICK SCURY GASP-0402-0001364	TURECOMO TOWING SAVANNAH GA	NON GC	
130	SPILLS	MIKE SCARBOROUGH GASP-0402-0010660	OLD US 80 ON TYBEE SAVANNAH GA	NON GC	
13	ERNS	MITSUMI SHIPPING CO 236111/MARINE- RELEASED FRO	PORT AUTHORITY C-2 ROW 25 SAVANNAH GA	NON GC	
131	SPILLS	MOBY RUTH GASP-0402-0001288	INNER MARINA SAVANNAH GA	NON GC	
132	SPILLS	MONTENAY SAVANNAH OPERATIONS, INC. GASP-0803-0000293	PRESIDENT STREET EXT SAVANNAH GA	NON GC	
133	SPILLS	MS. MOLLY/LAZARETTO SEAFOOD GASP-0402-0015508	BETWEEN BOAT RAMP AND BRIDGE SAVANNAH GA	NON GC	
134	SPILLS	MSR, INC. GASP-0402-0008771	PORT AUTHORITY SLIP #2 SAVANNAH GA	NON GC	
136	SPILLS	MV LONGBRANCH GASP-0303-0001536	TURNERS CREEK SAVANNAH GA	NON GC	
135	SPILLS	MV LONGBRANCH GASP-0402-0020805	TURNERS CREEK SAVANNAH GA	NON GC	
137	SPILLS	NATURE - ALGAE BLOOM GASP-0402-0008899	TIBY ISLAND SAVANNAH GA	NON GC	
138	SPILLS	NORFOLK SOUTHERN GASP-0402-0014669	INTERMODAL DRIVE SAVANNAH GA	NON GC	
14	ERNS	NORTON LILLY 534679/FIXED FACILITY	GEORGIA PORTS AUTHORITY SAVANNAH GA	NON GC	
139	SPILLS	OCCIDENTAL CHEMICAL GASP-0402-0006541	GATE 5 GA PORT AUTH SAVANNAH GA	NON GC	
15	ERNS	OCCURRED IN THE NORTH RAIL AREA NRC-520117/RAILROAD	HWY 80 ISLANDS EXPRESSWAY SAVANNAH GA	NON GC	
16	ERNS	OCEAN TERMINAL BERTH 20 ON THE SAVA NRC-631560/VESSEL	SAVANNAH GA	NON GC	
140	SPILLS	OETGENS RANCH GASP-0402-0007651	HWY 80 SAVANNAH GA	NON GC	
141	SPILLS	PAINT SPILL GASP-0402-0001105	COPPER FIELD PLANTATION S/D SAVANNAH GA	NON GC	

# *Environmental FirstSearch*

## *Sites Summary Report*

**TARGET SITE:** 12202 APACHE AVE  
SAVANNAH GA 31419

**JOB:** 03-0527.30  
PHASE I ESA

**TOTAL:** 291      **GEOCODED:** 6      **NON GEOCODED:** 285      **SELECTED:** 0

ID	DB Type	Site Name/ID/Status	Address	Dist/Dir	Map ID
17	ERNS	PETERSON MARINA 490332/MARINE VESSEL (EPA R	GARDEN CITY TERMINAL SAVANNAH GA	NON GC	
142	SPILLS	PLAN GEORGIA COMPANY GASP-0402-0010981	GA PORT AUTHORITY DOCK SAVANNAH GA	NON GC	
18	ERNS	PRESIDENT STREET EXTENSION WEST BOU NRC-619615/MOBILE	SAVANNAH GA	NON GC	
143	SPILLS	R.M. HARVEY GASP-0402-0003207	SAVANNAH GA	NON GC	
144	SPILLS	RESIDENT GASP-0803-0000414	QUACCO ROAD SAVANNAH GA 31419	NON GC	
291	UST	ROBERT F BROGDON 4250032	RFD 4 BOX 297^ SAVANNAH GA 31419	NON GC	
145	SPILLS	SAILOR S OIL GASP-0402-0008522	SAVANNAH GA	NON GC	
148	SPILLS	SAVANNAH ELECTRIC GASP-0402-0010581	9 LANGLEY DRIVE SAVANNAH GA	NON GC	
149	SPILLS	SAVANNAH ELECTRIC GASP-0402-0011045	US HWY 80E SAVANNAH GA	NON GC	
150	SPILLS	SAVANNAH ELECTRIC GASP-0402-0017387	W. LANETT LANE SAVANNAH GA	NON GC	
151	SPILLS	SAVANNAH ELECTRIC GASP-0402-0010953	BOULEVARD SUBSTATION SAVANNAH GA	NON GC	
152	SPILLS	SAVANNAH ELECTRIC GASP-0402-0010937	11 LYPSCON HALL RD SAVANNAH GA	NON GC	
153	SPILLS	SAVANNAH ELECTRIC GASP-0402-0008640	WHITFIELD MOBILE HOME PARK SAVANNAH GA	NON GC	
154	SPILLS	SAVANNAH ELECTRIC GASP-0402-0007293	BASIN ROAD OFF HWY 17 SOUTH SAVANNAH GA 31419	NON GC	
147	SPILLS	SAVANNAH ELECTRIC GASP-0402-0007306	DEPTFORD SUBSTATION AT PRESIDE SAVANNAH GA	NON GC	
146	SPILLS	SAVANNAH ELECTRIC GASP-0402-0001634	WILLINGTON ISLAND TOWNHOMES, A SAVANNAH GA	NON GC	
19	ERNS	SAVANNAH ELECTRIC - POWER 479213/HIGHWAY RELATED	SAVANNAH COCOA SAVANNAH GA	NON GC	
155	SPILLS	SAVANNAH ELECTRIC & POWER GASP-0402-0011499	912 COBBLE STREET SAVANNAH GA	NON GC	
156	SPILLS	SAVANNAH ELECTRIC & POWER CO GASP-0402-0007554	1710 CYLO SHONEY ROAD SAVANNAH GA	NON GC	
157	SPILLS	SAVANNAH ELECTRIC AND POWER GASP-0402-0008856	GROSS POINT ROAD SAVANNAH GA	NON GC	

# *Environmental FirstSearch*

## *Sites Summary Report*

**TARGET SITE:** 12202 APACHE AVE  
SAVANNAH GA 31419

**JOB:** 03-0527.30  
PHASE I ESA

**TOTAL:** 291      **GEOCODED:** 6      **NON GEOCODED:** 285      **SELECTED:** 0

ID	DB Type	Site Name/ID/Status	Address	Dist/Dir	Map ID
158	SPILLS	SAVANNAH ELECTRIC AND POWER CO GASP-0402-0011364	LAZERETTE CREEK 25 FEET FROM M SAVANNAH GA	NON GC	
159	SPILLS	SAVANNAH ELECTRIC CO GASP-0402-0010690	COFFEE BLUFF ROAD SAVANNAH GA 31419	NON GC	
20	ERNS	SAVANNAH HOUSING AUTH. 504049/UNKNOWN	VARIOUS HOUSING PROJECTS (GARD SAVANNAH GA	NON GC	
160	SPILLS	SAVANNAH PINES MHP GASP-0402-0019745	SAVANNAH PINES MHP LOCATED OFF SAVANNAH GA	NON GC	
161	SPILLS	SAVANNAH PINES MHP GASP-0303-0000476	SAVANNAH PINES MHP LOCATED OFF SAVANNAH GA	NON GC	
162	SPILLS	SAVANNAH PORT TERMINAL RR GASP-0402-0016647	INSIDE GEORGIA PORTS AUTHORITY SAVANNAH GA	NON GC	
163	SPILLS	SAVANNAH PORTS AUTHORITY GASP-0402-0023056	BERTH 13 OCEAN TERMINAL SAVANNAH GA 31419	NON GC	
164	SPILLS	SAVANNAH POWER GASP-0402-0010107	WILMINGTON ISLAND SAVANNAH GA	NON GC	
165	SPILLS	SAVANNAH POWER & ELECTRIC GASP-0402-0010806	@ SAVANNAH COCA COLA FACILITY SAVANNAH GA	NON GC	
166	SPILLS	SAVANNAH RIVER SITE GASP-0402-0014712	SAVANNAH GA	NON GC	
167	SPILLS	SAVANNAH RIVER SITE GASP-0402-0022229	SAVANNAH RIVER SITE SAVANNAH GA	NON GC	
168	SPILLS	SAVANNAH TRUCK RESTORING GASP-0402-0010623	NORTH GAMBLE RD OFF HWY 17 NEA SAVANNAH GA	NON GC	
169	SPILLS	SAVANNAH WATER & SEWER GASP-0802-0000288	PRESIDENT STREET EXTENSION BET SAVANNAH GA	NON GC	
170	SPILLS	SAVANNAH WATER SEWER SERVICES (912- GASP-0802-0000219	SPANISH MOSS ROAD NEAR PLANTAT SAVANNAH GA 31419	NON GC	
7	CERCLIS	SEA STAR TRUCK RELEASE GASFN0407132/NOT PROPOSED	SAVANNAH GA	NON GC	
171	SPILLS	SEAR INTERNATIONAL MAGASINFGATAN GASP-0402-0018263	NATIONAL GYPSUM BERTH SAVANNAH GA	NON GC	
172	SPILLS	SEE COMMENTS GASP-0402-0009444	HWY 17N OVER RIVER JUST BEFORE SAVANNAH GA	NON GC	
173	SPILLS	SENATOR SHIPING LINE GASP-0402-0016496	PORT OF SAVANNAH: ROW 4, BERTH SAVANNAH GA	NON GC	
174	SPILLS	SHEEN ON RIVER GASP-0402-0005142	ENTER MARINE SHIPYARD SAVANNAH GA	NON GC	
175	SPILLS	SHEEN ON WATERWAY GASP-0402-0002827	SAVANNAH GA	NON GC	

# *Environmental FirstSearch*

## *Sites Summary Report*

**TARGET SITE:** 12202 APACHE AVE  
SAVANNAH GA 31419

**JOB:** 03-0527.30  
PHASE I ESA

**TOTAL:** 291      **GEOCODED:** 6      **NON GEOCODED:** 285      **SELECTED:** 0

ID	DB Type	Site Name/ID/Status	Address	Dist/Dir	Map ID
176	SPILLS	SHEEN ON WATERWAY GASP-0402-0022932	HOGAN S MARINA SAVANNAH GA	NON GC	
177	SPILLS	SOUTHERN CHAMPION CONTRUCTION GASP-0402-0009975	OUT FALLOUT AT KEMIRA, INC EAS SAVANNAH GA	NON GC	
178	SPILLS	SPEEDY OIL CHANGE GASP-0803-0000226	SAVANNAH GA	NON GC	
179	SPILLS	SPILL GASP-0402-0018278	MARINA MM 583 SAVANNAH GA	NON GC	
180	SPILLS	STRACHAN SHIPPING COMPANY GASP-0402-0010165	U.S. 307 @ S.R. 21 IN PARKING SAVANNAH GA	NON GC	
21	ERNS	STRAHAN SHIPPING 463303/HIGHWAY RELATED	GARDEN CITY TERMINAL SAVANNAH GA	NON GC	
181	SPILLS	SUSP: PENN MARITIME COMPANY GASP-0402-0016313	COLONIAL FUEL DOCKS SAVANNAH GA	NON GC	
182	SPILLS	SUSPECT: BULL RIVER YACHT CLUB GASP-0402-0018655	HWY 80 EAST AT BULL RIVER YACH SAVANNAH GA	NON GC	
183	SPILLS	SUSPECT: LCDR STILLMAN, US NAVY-USS GASP-0402-0023009	OCEAN TERMINAL SAVANNAH GA	NON GC	
184	SPILLS	TERRY HUGGENS GASP-0402-0014372	SAVANNAH GA	NON GC	
185	SPILLS	TIRE PLUS GASP-1002-0000143	2410 GATEWAY ROAD AT TIRE PLUS SAVANNAH GA 31419	NON GC	
186	SPILLS	TOPAZ SMQISVCS-PILOT JOHN EBERWAN GASP-0402-0001336	SAVANNAH RIVER ON SANDBAR AT B SAVANNAH GA	NON GC	
187	SPILLS	TURKISH NAVY GASP-0402-0014364	DENTON S SHIPYARD, PIER D SAVANNAH GA	NON GC	
188	SPILLS	UHHHHHH???? GASP-0402-0009408	OFF HWY 80 & BRYAN WOODS TO PE SAVANNAH GA	NON GC	
189	SPILLS	UNION CAMP GASP-0402-0007275	ON RAILROAD YARD OFF BAY STREE SAVANNAH GA	NON GC	
190	SPILLS	UNION CAMP GASP-0402-0008417	#6 PAPER MACHINE AND PLANT SIT SAVANNAH GA	NON GC	
191	SPILLS	UNION CAMP GASP-0402-0010142	WWT SYSTEM ON HUTCHENSON ISLAN SAVANNAH GA	NON GC	
192	SPILLS	UNION CAMP GASP-0402-0010196	PLANT SITE SAVANNAH GA	NON GC	
193	SPILLS	UNION CAMP GASP-0402-0007294	T4 DISTILLATION TOWER SAVANNAH GA	NON GC	
22	ERNS	UNION CARBIDE 590918/HIGHWAY RELATED	PORT AUTHORITY CFS 2 WAREHOUSE SAVANNAH GA	NON GC	

# *Environmental FirstSearch*

## *Sites Summary Report*

**TARGET SITE:** 12202 APACHE AVE  
SAVANNAH GA 31419

**JOB:** 03-0527.30  
PHASE I ESA

**TOTAL:** 291      **GEOCODED:** 6      **NON GEOCODED:** 285      **SELECTED:** 0

ID	DB Type	Site Name/ID/Status	Address	Dist/Dir	Map ID
194	SPILLS	UNIVERSAL CONSTRUCTION GASP-0402-0007241	KING GEORGE BLVD AT FOREST COV SAVANNAH GA 31419	NON GC	
23	ERNS	UNK 232319/HIGHWAY RELATED	I-95 NORTH AT GA. VISITORS STA SAVANNAH GA	NON GC	
197	SPILLS	UNK GASP-0402-0022356	OFF OF HWY 204 AT SHOEMAN S PI SAVANNAH GA	NON GC	
196	SPILLS	UNK GASP-0402-0018825	CITGO SAVANNAH DOCK SAVANNAH GA	NON GC	
195	SPILLS	UNK GASP-0402-0011602	AT ANCHORAGE OF SEA BUOY APPRO SAVANNAH GA	NON GC	
198	SPILLS	UNK GASP-0402-0016473	HWY 17 DOWN STREAM TO LITTLE O SAVANNAH GA	NON GC	
226	SPILLS	UNKNOWN GASP-0803-0000396	BERTH 16, OCEAN TERMINAL, GEORG SAVANNAH GA	NON GC	
215	SPILLS	UNKNOWN GASP-0402-0011538	HYATT REGENCY EAST > 1/4 MI. SAVANNAH GA	NON GC	
220	SPILLS	UNKNOWN GASP-0402-0005973	HYATT ON RIVER STREET SAVANNAH GA	NON GC	
221	SPILLS	UNKNOWN GASP-0303-0001609	I-95 AT THE STATE LINE SAVANNAH GA	NON GC	
222	SPILLS	UNKNOWN GASP-0303-0002330	WESTIN HOTEL ON EAST SIDE OF S SAVANNAH GA	NON GC	
223	SPILLS	UNKNOWN GASP-0503-0000250	COLONIAL DOCK 1 NO PHYSICAL ADD SAVANNAH GA	NON GC	
219	SPILLS	UNKNOWN GASP-0402-0008711	OAKTREE ARTS. SAVANNAH GA	NON GC	
225	SPILLS	UNKNOWN GASP-0803-0000470	AT RIVER EAST OF LANDINGS MARI SAVANNAH GA	NON GC	
227	SPILLS	UNKNOWN GASP-0803-0000240	N32.00.50 W80.59.30 SAVANNAH GA	NON GC	
228	SPILLS	UNKNOWN GASP-0503-0000270	SAVANNAH GA	NON GC	
229	SPILLS	UNKNOWN GASP-0303-0002882	KILKENNY CREEK SAVANNAH GA	NON GC	
230	SPILLS	UNKNOWN GASP-0303-0002160	BRIDGE OVER JEKYLL CREEK SAVANNAH GA	NON GC	
224	SPILLS	UNKNOWN GASP-0803-0000601	BESIDE THE CITGO REFINERY SAVANNAH GA	NON GC	
207	SPILLS	UNKNOWN GASP-0402-0019469	THUNDERBOLT ISLAND MM583 SAVANNAH GA	NON GC	



# Environmental FirstSearch

## Sites Summary Report

**TARGET SITE:** 12202 APACHE AVE  
SAVANNAH GA 31419

**JOB:** 03-0527.30  
PHASE I ESA

**TOTAL:** 291      **GEOCODED:** 6      **NON GEOCODED:** 285      **SELECTED:** 0

ID	DB Type	Site Name/ID/Status	Address	Dist/Dir	Map ID
203	SPILLS	UNKNOWN GASP-0402-0021597	WESTIN HOTEL ON EAST SIDE OF S SAVANNAH GA	NON GC	
202	SPILLS	UNKNOWN GASP-0402-0023466	JACKSON DOCK ON SAVANNAH GA	NON GC	
201	SPILLS	UNKNOWN GASP-0802-0000017	SAVANNAH GA	NON GC	
200	SPILLS	UNKNOWN GASP-0303-0001147	GA PORT AUTH./PORT BERTH 50/SA SAVANNAH GA	NON GC	
218	SPILLS	UNKNOWN GASP-0402-0010527	RIVER MARKER #17 SAVANNAH GA	NON GC	
217	SPILLS	UNKNOWN GASP-0402-0010531	OCEAN TERMINAL SAVANNAH GA	NON GC	
199	SPILLS	UNKNOWN GASP-0402-0001211	VICINITY OF LITTLE RIVER & ATL SAVANNAH GA	NON GC	
204	SPILLS	UNKNOWN GASP-0402-0021428	BRIDGE OVER JEKYLL CREEK SAVANNAH GA	NON GC	
206	SPILLS	UNKNOWN GASP-0402-0020372	GA PORT AUTH./PORT BERTH 50/SA SAVANNAH GA	NON GC	
208	SPILLS	UNKNOWN GASP-0402-0016550	IN SAVANNAH RIVER SAVANNAH GA	NON GC	
209	SPILLS	UNKNOWN GASP-0402-0016464	ON RIVER IN FRONT OF HWATT HOT SAVANNAH GA	NON GC	
210	SPILLS	UNKNOWN GASP-0303-0000555	RIVER STREET SAVANNAH GA	NON GC	
211	SPILLS	UNKNOWN GASP-0303-0000195	THINDERBOLT ISLAND MM583 SAVANNAH GA	NON GC	
212	SPILLS	UNKNOWN GASP-1002-0000253	TYBEE ISLAND AT THE STATION SAVANNAH GA	NON GC	
213	SPILLS	UNKNOWN GASP-0802-0000107	1 MILE FROM TALMADGE BRIDGE SAVANNAH GA	NON GC	
214	SPILLS	UNKNOWN GASP-0802-0000040	I-95 WESTBOUND AT MM 39 SAVANNAH GA	NON GC	
216	SPILLS	UNKNOWN GASP-0402-0010976	GA PORT AUTHORITY CONTAINER BE SAVANNAH GA	NON GC	
205	SPILLS	UNKNOWN GASP-0402-0020878	I-95 AT THE STATE LINE SAVANNAH GA	NON GC	
231	SPILLS	UNKNOWN - OIL SPILL GASP-0402-0001559	MILE MARKER 56 ON SAVANNAH RIV SAVANNAH GA	NON GC	
232	SPILLS	UNKNOWN - OIL SPILL GASP-0402-0010886	OFF COLONIAL OIL DOCK SAVANNAH GA	NON GC	

# *Environmental FirstSearch*

## *Sites Summary Report*

**TARGET SITE:** 12202 APACHE AVE  
SAVANNAH GA 31419

**JOB:** 03-0527.30  
PHASE I ESA

**TOTAL:** 291      **GEOCODED:** 6      **NON GEOCODED:** 285      **SELECTED:** 0

ID	DB Type	Site Name/ID/Status	Address	Dist/Dir	Map ID
233	SPILLS	UNKNOWN - PUMP AND HAULER GASP-0402-0014737	S.W. BYPASS, 1-2 MILES SOUTH O SAVANNAH GA	NON GC	
234	SPILLS	UNKNOWN - ZINC PHOSPHIDE GASP-0402-0008428	GA. PORT WAREHOUSE SHED #15 SAVANNAH GA	NON GC	
235	SPILLS	UNKNOWN / FUEL SPILL GASP-0402-0019070	I-95 N JUST SOUTH OF I-16 SAVANNAH GA	NON GC	
236	SPILLS	UNKNOWN / GREEN SLIME ON CREEK GASP-0402-0015464	OFF WILMINGTON RIVER @ CREEK A SAVANNAH GA	NON GC	
237	SPILLS	UNKNOWN / OIL SEEPAGE GASP-0402-0006994	BATTERY POINT PLANTATION SUBDI SAVANNAH GA	NON GC	
238	SPILLS	UNKNOWN / OIL SHEEN GASP-0402-0014340	OCEAN TERMINALS 1 & 2 SAVANNAH GA	NON GC	
242	SPILLS	UNKNOWN / OIL SPILL GASP-0402-0009813	FELL STREET LIFT STATION BY OC SAVANNAH GA	NON GC	
241	SPILLS	UNKNOWN / OIL SPILL GASP-0402-0022727	LOTTS ISLAND ON BASE SAVANNAH GA	NON GC	
239	SPILLS	UNKNOWN / OIL SPILL GASP-0402-0009136	VICTORY DRIVE @ WILMINGTON RIV SAVANNAH GA	NON GC	
240	SPILLS	UNKNOWN / OIL SPILL GASP-0402-0014785	OCEAN TERMINAL SAVANNAH GA	NON GC	
243	SPILLS	UNKNOWN / PUMPING OF THE BILGES GASP-0402-0022791	WESTON HOTEL AT BOAT DOCK AND SAVANNAH GA	NON GC	
244	SPILLS	UNKNOWN / SEWAGE SPILL GASP-0402-0003480	120 SAIZE STREET SAVANNAH GA	NON GC	
259	SPILLS	UNKNOWN- ABANDONED DRUM GASP-0402-0008979	OCMULGEE WETLANDS SAVANNAH GA	NON GC	
245	SPILLS	UNKNOWN AT REPORT TIME GASP-0402-0009651	IN PROXIMITY OF COLLONIAL OIL SAVANNAH GA	NON GC	
246	SPILLS	UNKNOWN BURNING LEAVES GASP-0402-0014318	MONTGOMERY CROSSROADS AREA CR SAVANNAH GA	NON GC	
247	SPILLS	UNKNOWN CONTRACTOR GASP-0402-0020323	BRIDGE OVER TURNER CREEK ON HI SAVANNAH GA	NON GC	
248	SPILLS	UNKNOWN CONTRACTOR GASP-0303-0001101	BRIDGE OVER TURNER CREEK ON HI SAVANNAH GA	NON GC	
249	SPILLS	UNKNOWN OIL GASP-0402-0014137	STOCKBRIDGE ST, VILLAGE GREEN SAVANNAH GA 31419	NON GC	
250	SPILLS	UNKNOWN RADIOACTIVE GASP-0402-0017358	GEORGIA PORTS AUTHORITY SAVANNAH GA	NON GC	
251	SPILLS	UNKNOWN SEWAGE GASP-0402-0001416	I 95 SOUTH @EXIT 19 SAVANNAH GA	NON GC	

# *Environmental FirstSearch*

## *Sites Summary Report*

**TARGET SITE:** 12202 APACHE AVE  
SAVANNAH GA 31419

**JOB:** 03-0527.30  
PHASE I ESA

**TOTAL:** 291      **GEOCODED:** 6      **NON GEOCODED:** 285      **SELECTED:** 0

ID	DB Type	Site Name/ID/Status	Address	Dist/Dir	Map ID
252	SPILLS	UNKNOWN SHEEN GASP-0402-0015764	ON THE RIVER SAVANNAH GA	NON GC	
254	SPILLS	UNKNOWN SHEEN GASP-0303-0001325	ICW NO MILE MARKER SPECIFIED SAVANNAH GA	NON GC	
253	SPILLS	UNKNOWN SHEEN GASP-0402-0020595	ICW NO MILE MARKER SPECIFIED SAVANNAH GA	NON GC	
255	SPILLS	UNKNOWN SPILL GASP-0402-0009246	GA VISITORS CENTER SAVANNAH GA	NON GC	
256	SPILLS	UNKNOWN SUBSTANCE GASP-0402-0001365	GEORGIA PORT AUTHORITY SAVANNAH GA	NON GC	
257	SPILLS	UNKNOWN VEGETATION KILL GASP-0402-0011652	MP 497 TO 499 ON SCL LINES (CS SAVANNAH GA	NON GC	
258	SPILLS	UNKNOWN, ODOR GASP-0402-0006654	SAVANNAH GA	NON GC	
261	SPILLS	UNKNOWN/DRUM IN RIVER GASP-0402-0000929	BUOY #60 SAVANNAH GA	NON GC	
262	SPILLS	UNKNOWN/DRUMS IN RIVER GASP-0402-0011847	DM 25 SAVANNAH GA	NON GC	
260	SPILLS	UNKNOWN-CHEMICAL SPRAY GASP-0402-0010899	UNKNOWN SAVANNAH GA	NON GC	
263	SPILLS	UNKNOWNFUEL SPILL GASP-0402-0009242	I95 SOUTH SAVANNAH GA	NON GC	
264	SPILLS	UNKOWN FUEL SPILL GASP-0402-0009680	I-16W AND 37 SAVANNAH GA	NON GC	
265	SPILLS	UNKOWN ODOR GASP-0402-0018355	GATEWAY INDUSTRIAL BLVD SAVANNAH GA	NON GC	
266	SPILLS	UNKOWN OIL SPILL GASP-0402-0009303	AT SEPCO SAVANNAH GA	NON GC	
267	SPILLS	UNOCAL GASP-0402-0007587	PLANT SITE SAVANNAH GA	NON GC	
24	ERNS	US ARMY 507935/FIXED FACILITY	STACK 7 GEORGIA PORT AUTHORITY SAVANNAH GA	NON GC	
268	SPILLS	US NAVY GASP-0402-0018155	BELLS LANDING SAVANNAH GA	NON GC	
269	SPILLS	USCGMC/ CENTRAL OF GA. R.R.(DEFUNCT GASP-0402-0007336	LATHRUP SAVANNAH GA	NON GC	
270	SPILLS	VILLAGE GAS STATION GASP-0402-0007424	VILLAGE GAS STATION ON SKIDAWA SAVANNAH GA	NON GC	
271	SPILLS	VILLAGE STATION GASP-0402-0006698	AT STATION SAVANNAH GA	NON GC	

***Environmental FirstSearch  
Sites Summary Report***

**TARGET SITE:** 12202 APACHE AVE  
SAVANNAH GA 31419

**JOB:** 03-0527.30  
PHASE I ESA

**TOTAL:** 291      **GEOCODED:** 6      **NON GEOCODED:** 285      **SELECTED:** 0

ID	DB Type	Site Name/ID/Status	Address	Dist/Dir	Map ID
272	SPILLS	W.E. SILLS MOTOR COMPANY GASP-0402-0011097	SAVANNAH GA	NON GC	
273	SPILLS	WASTE SYSTEMS OF SAVANNAH GASP-0402-0016623	NORTH CROMWELL ROAD AND FAIRFI SAVANNAH GA	NON GC	
274	SPILLS	WESTERN AUTO GASP-0402-0006696	WESTERN AUTO IN GARDEN CITY SAVANNAH GA	NON GC	
275	SPILLS	ZELOS TRUCKING GASP-0402-0019199	I-95 NORTH BOUND AT MILEPOST 1 SAVANNAH GA	NON GC	
276	SPILLS	ZIM LINES GASP-0402-0014650	GATE #3 GEORGIA PORTS AUTHORIT SAVANNAH GA	NON GC	

**Environmental FirstSearch**  
**Site Detail Report**

**TARGET SITE:** 12202 APACHE AVE  
SAVANNAH GA 31419

**JOB:** 03-0527.30  
PHASE I ESA

**REGISTERED UNDERGROUND STORAGE TANKS**

**SEARCH ID:** 1                      **DIST/DIR:** 0.00 --                      **MAP ID:** 3

**NAME:** ENMARK ABERCORN #010  
**ADDRESS:** 14000 ABERCORN ST  
SAVANNAH GA 31419

**REV:** 4/11/01  
**ID1:** 4250431  
**ID2:**  
**STATUS:**  
**PHONE:** 9122361331

**CONTACT:** DAVID HIGGS

**TANK OWNER INFORMATION**

**OWNER ID:** 19  
**OWNER NAME:** ENMARK STATIONS, INC  
**OWNER ADDRESS:** PO BOX 728^NORTH LATHROP AVE  
SAVANNAH GA 31402  
**OWNER TELEPHONE:** 9122361331

**FACILITY INFORMATION**

**FACILITY CONTACT NAME:** DAVID HIGGS  
**FACILITY CONTACT ADDRESS:** PO BOX 728  
SAVANNAH GA 31402  
**FACILITY CONTACT TELEPHONE:** 9122361331

**TOTAL NUMBER OF TANKS:** 6  
**NUMBER OF TANKS IN SERVICE:** 6  
**NUMBER OF CLOSED/REMOVED TANKS:** 0  
**TYPE OF FACILITY:** Commercial  
**TYPE OF OWNER:** Commercial

**TANK NUMBER:** 1  
**TANK STATUS:** Currently in Use  
**CONTENTS:** Gasoline  
**TANK CAPACITY IN GALLONS:** 12000  
**DATE INSTALLED:** 05/05/85  
**DATE CLOSED:**  
**AGE OF TANK:** 15  
**TANK MATERIAL:** Composite^Double Walled  
**PIPING METHOD:** Fiberglass/Plastic^  
**TANK RELEASE DETECTION:** Tnk Tightness Testing^I  
**PIPE RELEASE DETECTION:** Auto Line Leak Detector  
**DATE OVERFILL PROTECTION INSTALLED:** 05/05/1985  
**DATE SPILL PROTECTION INSTALLED:** 05/05/1985  
**DATE IMPRESSED CURRENT INSTALLED:**  
**DATE GALVANIC SYSTEM INSTALLED:**  
**IF TANK IS CLOSED, WAS IT REMOVED (Y/N)?**  
**IF TANK IS CLOSED, WAS IT FILLED IN PLACE (Y/N)?**  
**IS THIS A FEDERALLY REGULATED TANK (Y/N)?** Y

**TANK NUMBER:** 2  
**TANK STATUS:** Currently in Use  
**CONTENTS:** Gasoline  
**TANK CAPACITY IN GALLONS:** 12000

- Continued on next page -

**Environmental FirstSearch**  
**Site Detail Report**

**TARGET SITE:** 12202 APACHE AVE  
SAVANNAH GA 31419

**JOB:** 03-0527.30  
**PHASE I ESA**

**REGISTERED UNDERGROUND STORAGE TANKS**

**SEARCH ID:** 1                      **DIST/DIR:** 0.00 --                      **MAP ID:** 3

**NAME:** ENMARK ABERCORN #010  
**ADDRESS:** 14000 ABERCORN ST  
SAVANNAH GA 31419

**REV:** 4/11/01  
**ID1:** 4250431  
**ID2:**  
**STATUS:**  
**PHONE:** 9122361331

**CONTACT:** DAVID HIGGS

**DATE INSTALLED:** 05/05/85  
**DATE CLOSED:**  
**AGE OF TANK:** 15  
**TANK MATERIAL:** Composite^Polyethylene Tan  
**PIPING METHOD:** Fiberglass/Plastic^  
**TANK RELEASE DETECTION:** Tnk Tightness Testing^I  
**PIPE RELEASE DETECTION:** Auto Line Leak Detector  
**DATE OVERFILL PROTECTION INSTALLED:** 05/05/1985  
**DATE SPILL PROTECTION INSTALLED:** 05/05/1985  
**DATE IMPRESSED CURRENT INSTALLED:**  
**DATE GALVANIC SYSTEM INSTALLED:**  
**IF TANK IS CLOSED, WAS IT REMOVED (Y/N)?**  
**IF TANK IS CLOSED, WAS IT FILLED IN PLACE (Y/N)?**  
**IS THIS A FEDERALLY REGULATED TANK (Y/N)?** Y

**TANK NUMBER:** 3  
**TANK STATUS:** Currently in Use  
**CONTENTS:** Gasoline  
**TANK CAPACITY IN GALLONS:** 12000  
**DATE INSTALLED:** 05/05/85  
**DATE CLOSED:**  
**AGE OF TANK:** 15  
**TANK MATERIAL:** Composite^Double Walled  
**PIPING METHOD:** Fiberglass/Plastic^  
**TANK RELEASE DETECTION:** Tnk Tightness Testing^I  
**PIPE RELEASE DETECTION:** Auto Line Leak Detector  
**DATE OVERFILL PROTECTION INSTALLED:** 05/05/1985  
**DATE SPILL PROTECTION INSTALLED:** 05/05/1985  
**DATE IMPRESSED CURRENT INSTALLED:**  
**DATE GALVANIC SYSTEM INSTALLED:**  
**IF TANK IS CLOSED, WAS IT REMOVED (Y/N)?**  
**IF TANK IS CLOSED, WAS IT FILLED IN PLACE (Y/N)?**  
**IS THIS A FEDERALLY REGULATED TANK (Y/N)?** Y

**TANK NUMBER:** 4  
**TANK STATUS:** Currently in Use  
**CONTENTS:** Gasoline  
**TANK CAPACITY IN GALLONS:** 8200  
**DATE INSTALLED:** 01/24/87  
**DATE CLOSED:**  
**AGE OF TANK:** 14  
**TANK MATERIAL:** Composite^Double Walled  
**PIPING METHOD:** Fiberglass/Plastic^  
**TANK RELEASE DETECTION:** Tnk Tightness Testing^I  
**PIPE RELEASE DETECTION:** Auto Line Leak Detector

- Continued on next page -

**Environmental FirstSearch**  
**Site Detail Report**

**TARGET SITE:** 12202 APACHE AVE  
SAVANNAH GA 31419

**JOB:** 03-0527.30  
**PHASE I ESA**

**REGISTERED UNDERGROUND STORAGE TANKS**

**SEARCH ID:** 1                      **DIST/DIR:** 0.00 --                      **MAP ID:** 3

**NAME:** ENMARK ABERCORN #010  
**ADDRESS:** 14000 ABERCORN ST  
SAVANNAH GA 31419

**REV:** 4/11/01  
**ID1:** 4250431  
**ID2:**  
**STATUS:**  
**PHONE:** 9122361331

**CONTACT:** DAVID HIGGS

**DATE OVERFILL PROTECTION INSTALLED:** 05/05/1985  
**DATE SPILL PROTECTION INSTALLED:** 05/05/1985  
**DATE IMPRESSED CURRENT INSTALLED:**  
**DATE GALVANIC SYSTEM INSTALLED:**  
**IF TANK IS CLOSED, WAS IT REMOVED (Y/N)?**  
**IF TANK IS CLOSED, WAS IT FILLED IN PLACE (Y/N)?**  
**IS THIS A FEDERALLY REGULATED TANK (Y/N)?** Y

**TANK NUMBER:** 5  
**TANK STATUS:** Currently in Use  
**CONTENTS:** Diesel  
**TANK CAPACITY IN GALLONS:** 6000  
**DATE INSTALLED:** 05/05/85  
**DATE CLOSED:**  
**AGE OF TANK:** 15  
**TANK MATERIAL:** Composite^Double Walled  
**PIPING METHOD:** Fiberglass/Plastic^  
**TANK RELEASE DETECTION:** Tnk Tightness Testing^I  
**PIPE RELEASE DETECTION:** Auto Line Leak Detector  
**DATE OVERFILL PROTECTION INSTALLED:** 05/05/1985  
**DATE SPILL PROTECTION INSTALLED:** 05/05/1985  
**DATE IMPRESSED CURRENT INSTALLED:**  
**DATE GALVANIC SYSTEM INSTALLED:**  
**IF TANK IS CLOSED, WAS IT REMOVED (Y/N)?**  
**IF TANK IS CLOSED, WAS IT FILLED IN PLACE (Y/N)?**  
**IS THIS A FEDERALLY REGULATED TANK (Y/N)?** Y

**TANK NUMBER:** 6  
**TANK STATUS:** Currently in Use  
**CONTENTS:** Diesel  
**TANK CAPACITY IN GALLONS:** 6000  
**DATE INSTALLED:** 05/05/85  
**DATE CLOSED:**  
**AGE OF TANK:** 15  
**TANK MATERIAL:** Composite^Double Walled  
**PIPING METHOD:** Fiberglass/Plastic^  
**TANK RELEASE DETECTION:** Tnk Tightness Testing^I  
**PIPE RELEASE DETECTION:** Auto Line Leak Detector  
**DATE OVERFILL PROTECTION INSTALLED:** 05/05/1985  
**DATE SPILL PROTECTION INSTALLED:** 05/05/1985  
**DATE IMPRESSED CURRENT INSTALLED:**  
**DATE GALVANIC SYSTEM INSTALLED:**  
**IF TANK IS CLOSED, WAS IT REMOVED (Y/N)?**  
**IF TANK IS CLOSED, WAS IT FILLED IN PLACE (Y/N)?**  
**IS THIS A FEDERALLY REGULATED TANK (Y/N)?** Y

**Environmental FirstSearch  
Site Detail Report**

**TARGET SITE:** 12202 APACHE AVE  
SAVANNAH GA 31419

**JOB:** 03-0527.30  
PHASE I ESA

**LEAKING UNDERGROUND STORAGE TANKS**

**SEARCH ID:** 5

**DIST/DIR:** 0.00 --

**MAP ID:** 3

**NAME:** ENMARK ABERCORN #010  
**ADDRESS:** 14000 ABERCORN ST  
SAVANNAH GA 31419  
CHATHAM

**REV:** 3/1/03  
**ID1:** 4250431  
**ID2:**  
**STATUS:**  
**PHONE:**

**CONTACT:**

**SITE INFORMATION**

**DATE OF RELEASE:** 9/4/1991  
**MAJOR CODE:** CONFIRMED RELEASE  
**MINOR CODE:** RECEIVED  
**DATE RECEIVED:** 8/15/1991  
**PROJECT OFFICER:** BUERKLE,ANDREA C

**DATE OF RELEASE:** 8/15/1991  
**MAJOR CODE:** SUSPECTED RELEASE  
**MINOR CODE:** RECEIVED  
**DATE RECEIVED:** 11/20/1990  
**PROJECT OFFICER:** BUERKLE,ANDREA C

**DATE OF RELEASE:** 8/15/1991  
**MAJOR CODE:** CONFIRMED RELEASE  
**MINOR CODE:** RECEIVED  
**DATE RECEIVED:** 8/15/1991  
**PROJECT OFFICER:** BUERKLE,ANDREA C

**DATE OF RELEASE:** 9/4/1991  
**MAJOR CODE:** SUSPECTED RELEASE  
**MINOR CODE:** RECEIVED  
**DATE RECEIVED:** 11/20/1990  
**PROJECT OFFICER:** BUERKLE,ANDREA C

**DATE OF RELEASE:** 8/15/1991  
**MAJOR CODE:** CONFIRMED RELEASE  
**MINOR CODE:** RECEIVED  
**DATE RECEIVED:** 9/4/1991  
**PROJECT OFFICER:** BUERKLE,ANDREA C

**DATE OF RELEASE:** 9/4/1991  
**MAJOR CODE:** CONFIRMED RELEASE  
**MINOR CODE:** RECEIVED  
**DATE RECEIVED:** 9/4/1991  
**PROJECT OFFICER:** BUERKLE,ANDREA C



**Environmental FirstSearch**  
**Site Detail Report**

**TARGET SITE:** 12202 APACHE AVE  
SAVANNAH GA 31419

**JOB:** 03-0527.30  
**PHASE I ESA**

**REGISTERED UNDERGROUND STORAGE TANKS**

**SEARCH ID:** 2

**DIST/DIR:** 0.02 NE

**MAP ID:** 5

**NAME:** SHELL #19  
**ADDRESS:** 14001 ABERCORN STREET  
SAVANNAH GA 31409

**REV:** 4/11/01  
**ID1:** 9025219  
**ID2:**  
**STATUS:**  
**PHONE:** 9123523317

**CONTACT:** EMPIRE OIL COMPANY

**TANK OWNER INFORMATION**

**OWNER ID:** 2000815  
**OWNER NAME:** EMPIRE OIL CO  
**OWNER ADDRESS:** PO BOX 14299  
SAVANNAH GA 31416  
**OWNER TELEPHONE:** 9123523317

**FACILITY INFORMATION**

**FACILITY CONTACT NAME:** EMPIRE OIL COMPANY  
**FACILITY CONTACT ADDRESS:** PO BOX 14299  
SAVANNAH GA 31416  
**FACILITY CONTACT TELEPHONE:** 9123523317

**TOTAL NUMBER OF TANKS:** 5  
**NUMBER OF TANKS IN SERVICE:** 5  
**NUMBER OF CLOSED/REMOVED TANKS:** 0  
**TYPE OF FACILITY:** Gas Station  
**TYPE OF OWNER:** Commercial

**TANK NUMBER:** 1  
**TANK STATUS:** Currently in Use  
**CONTENTS:** Gasoline  
**TANK CAPACITY IN GALLONS:** 8000  
**DATE INSTALLED:** 01/01/90  
**DATE CLOSED:**  
**AGE OF TANK:** 11  
**TANK MATERIAL:** Epoxy Coated Steel  
**PIPING METHOD:** Fiberglass/Plastic  
**TANK RELEASE DETECTION:** Auto Tank Gauging  
**PIPE RELEASE DETECTION:** Auto Line Leak Detector  
**DATE OVERFILL PROTECTION INSTALLED:** 11/01/1993  
**DATE SPILL PROTECTION INSTALLED:** 11/01/1993  
**DATE IMPRESSED CURRENT INSTALLED:**  
**DATE GALVANIC SYSTEM INSTALLED:**  
**IF TANK IS CLOSED, WAS IT REMOVED (Y/N)?**  
**IF TANK IS CLOSED, WAS IT FILLED IN PLACE (Y/N)?**  
**IS THIS A FEDERALLY REGULATED TANK (Y/N)?** Y

**TANK NUMBER:** 2  
**TANK STATUS:** Currently in Use  
**CONTENTS:** Gasoline  
**TANK CAPACITY IN GALLONS:** 8000

- Continued on next page -

**Environmental FirstSearch**  
**Site Detail Report**

**TARGET SITE:** 12202 APACHE AVE  
SAVANNAH GA 31419

**JOB:** 03-0527.30  
**PHASE I ESA**

**REGISTERED UNDERGROUND STORAGE TANKS**

**SEARCH ID:** 2                      **DIST/DIR:** 0.02 NE                      **MAP ID:** 5

**NAME:** SHELL #19  
**ADDRESS:** 14001 ABERCORN STREET  
SAVANNAH GA 31409

**REV:** 4/11/01  
**ID1:** 9025219  
**ID2:**  
**STATUS:**  
**PHONE:** 9123523317

**CONTACT:** EMPIRE OIL COMPANY

**DATE INSTALLED:** 01/01/90  
**DATE CLOSED:**  
**AGE OF TANK:** 11  
**TANK MATERIAL:** Epoxy Coated Steel  
**PIPING METHOD:** Fiberglass/Plastic  
**TANK RELEASE DETECTION:** Auto Tank Gauging  
**PIPE RELEASE DETECTION:** Auto Line Leak Detector  
**DATE OVERFILL PROTECTION INSTALLED:** 11/01/1993  
**DATE SPILL PROTECTION INSTALLED:** 11/01/1993  
**DATE IMPRESSED CURRENT INSTALLED:**  
**DATE GALVANIC SYSTEM INSTALLED:**  
**IF TANK IS CLOSED, WAS IT REMOVED (Y/N)?**  
**IF TANK IS CLOSED, WAS IT FILLED IN PLACE (Y/N)?**  
**IS THIS A FEDERALLY REGULATED TANK (Y/N)?** Y

**TANK NUMBER:** 3  
**TANK STATUS:** Currently in Use  
**CONTENTS:** Gasoline  
**TANK CAPACITY IN GALLONS:** 10000  
**DATE INSTALLED:** 01/01/90  
**DATE CLOSED:**  
**AGE OF TANK:** 11  
**TANK MATERIAL:** Epoxy Coated Steel  
**PIPING METHOD:** Fiberglass/Plastic  
**TANK RELEASE DETECTION:** Auto Tank Gauging  
**PIPE RELEASE DETECTION:** Auto Line Leak Detector  
**DATE OVERFILL PROTECTION INSTALLED:** 11/01/1993  
**DATE SPILL PROTECTION INSTALLED:** 11/01/1993  
**DATE IMPRESSED CURRENT INSTALLED:**  
**DATE GALVANIC SYSTEM INSTALLED:**  
**IF TANK IS CLOSED, WAS IT REMOVED (Y/N)?**  
**IF TANK IS CLOSED, WAS IT FILLED IN PLACE (Y/N)?**  
**IS THIS A FEDERALLY REGULATED TANK (Y/N)?** Y

**TANK NUMBER:** 4  
**TANK STATUS:** Currently in Use  
**CONTENTS:** Gasoline  
**TANK CAPACITY IN GALLONS:** 10000  
**DATE INSTALLED:** 01/01/90  
**DATE CLOSED:**  
**AGE OF TANK:** 11  
**TANK MATERIAL:** Epoxy Coated Steel  
**PIPING METHOD:** Fiberglass/Plastic  
**TANK RELEASE DETECTION:** Auto Tank Gauging  
**PIPE RELEASE DETECTION:** Auto Line Leak Detector

- Continued on next page -

**Environmental FirstSearch  
Site Detail Report**

**TARGET SITE:** 12202 APACHE AVE  
SAVANNAH GA 31419

**JOB:** 03-0527.30  
**PHASE I ESA**

**REGISTERED UNDERGROUND STORAGE TANKS**

<b>SEARCH ID:</b> 2	<b>DIST/DIR:</b> 0.02 NE	<b>MAP ID:</b> 5
---------------------	--------------------------	------------------

<b>NAME:</b> SHELL #19	<b>REV:</b> 4/11/01
<b>ADDRESS:</b> 14001 ABERCORN STREET SAVANNAH GA 31409	<b>ID1:</b> 9025219
	<b>ID2:</b>
<b>CONTACT:</b> EMPIRE OIL COMPANY	<b>STATUS:</b>
	<b>PHONE:</b> 9123523317

<b>DATE OVERFILL PROTECTION INSTALLED:</b>	11/01/1993
<b>DATE SPILL PROTECTION INSTALLED:</b>	11/01/1993
<b>DATE IMPRESSED CURRENT INSTALLED:</b>	
<b>DATE GALVANIC SYSTEM INSTALLED:</b>	
<b>IF TANK IS CLOSED, WAS IT REMOVED (Y/N)?</b>	
<b>IF TANK IS CLOSED, WAS IT FILLED IN PLACE (Y/N)?</b>	
<b>IS THIS A FEDERALLY REGULATED TANK (Y/N)?</b>	Y

<b>TANK NUMBER:</b>	5
<b>TANK STATUS:</b>	Currently in Use
<b>CONTENTS:</b>	Diesel
<b>TANK CAPACITY IN GALLONS:</b>	4000
<b>DATE INSTALLED:</b>	01/01/90
<b>DATE CLOSED:</b>	
<b>AGE OF TANK:</b>	11
<b>TANK MATERIAL:</b>	Epoxy Coated Steel
<b>PIPING METHOD:</b>	Fiberglass/Plastic
<b>TANK RELEASE DETECTION:</b>	Auto Tank Gauging
<b>PIPE RELEASE DETECTION:</b>	Auto Line Leak Detector
<b>DATE OVERFILL PROTECTION INSTALLED:</b>	11/01/1993
<b>DATE SPILL PROTECTION INSTALLED:</b>	11/01/1993
<b>DATE IMPRESSED CURRENT INSTALLED:</b>	
<b>DATE GALVANIC SYSTEM INSTALLED:</b>	
<b>IF TANK IS CLOSED, WAS IT REMOVED (Y/N)?</b>	
<b>IF TANK IS CLOSED, WAS IT FILLED IN PLACE (Y/N)?</b>	
<b>IS THIS A FEDERALLY REGULATED TANK (Y/N)?</b>	Y

***Environmental FirstSearch  
Site Detail Report***

**TARGET SITE:** 12202 APACHE AVE  
SAVANNAH GA 31419

**JOB:** 03-0527.30  
PHASE I ESA

**LEAKING UNDERGROUND STORAGE TANKS**

**SEARCH ID:** 3                      **DIST/DIR:** 0.34 NW                      **MAP ID:** 2

**NAME:** 57 & 58 FOREST RIVER LOTS  
**ADDRESS:** 1132 & 1134 SHAWNEE AVENUE  
SAVANNAH GA 31419  
CHATHAM

**REV:** 3/1/03  
**ID1:** 9025305  
**ID2:**  
**STATUS:**  
**PHONE:**

**CONTACT:**

**SITE INFORMATION**

**DATE OF RELEASE:** 8/25/1998  
**MAJOR CODE:** CONFIRMED RELEASE  
**MINOR CODE:** RECEIVED  
**DATE RECEIVED:** 8/25/1998  
**PROJECT OFFICER:** LOGAN, WILLIAM E.

**LEAKING UNDERGROUND STORAGE TANKS**

**SEARCH ID:** 4                      **DIST/DIR:** 0.40 NE                      **MAP ID:** 1

**NAME:** BST/R2202/SVNHGAMG/BELL SOUTH  
**ADDRESS:** 12032 MIDDLEGROUND RD  
SAVANNAH GA 31419

**REV:** 3/1/03  
**ID1:** 9000274  
**ID2:**  
**STATUS:**  
**PHONE:**

**CONTACT:**

**SITE INFORMATION**

**DATE OF RELEASE:** 6/16/1989  
**MAJOR CODE:** CONFIRMED RELEASE  
**MINOR CODE:** RECEIVED  
**DATE RECEIVED:** 6/16/1989  
**PROJECT OFFICER:** JOHNSON, STEVE

***Environmental FirstSearch  
Site Detail Report***

**TARGET SITE:** 12202 APACHE AVE  
SAVANNAH GA 31419

**JOB:** 03-0527.30  
PHASE I ESA

**LEAKING UNDERGROUND STORAGE TANKS**

**SEARCH ID:** 6

**DIST/DIR:** 0.49 NW

**MAP ID:** 4

**NAME:** SAVANNAH MALL  
**ADDRESS:** RIO RD & ABERCORN ST EXT  
SAVANNAH GA 31419  
CHATHAM

**REV:** 3/1/03  
**ID1:** 9000356  
**ID2:**  
**STATUS:**  
**PHONE:**

**CONTACT:**

**SITE INFORMATION**

**DATE OF RELEASE:**  
**MAJOR CODE:** CONFIRMED RELEASE  
**MINOR CODE:** RECEIVED  
**DATE RECEIVED:** 11/6/1990  
**PROJECT OFFICER:** MILLER, MALLORY

## **Environmental FirstSearch Federal Databases and Sources**

### **ASTM Databases:**

**CERCLIS:** *Comprehensive Environmental Response Compensation and Liability Information System.* The EPA's database of current and potential Superfund sites currently or previously under investigation. Source: Environmental Protection Agency.

*Updated quarterly.*

**CERCLIS-NFRAP (Archive):** *Comprehensive Environmental Response Compensation and Liability Information System Archived Sites.* The Archive designation means that, to the best of EPA's knowledge, assessment at a site has been completed and that EPA has determined no further steps will be taken to list this site on the National Priorities List (NPL). This decision does not necessarily mean that there is no hazard associated with a given site; it only means that, based upon available information, the location is not judged to be a potential NPL site.

*Updated quarterly.*

**ERNS:** *Emergency Response Notification System.* The EPA's database of emergency response actions. Source: Environmental Protection Agency. Data since January, 2001, has been received from the National Response Center as the EPA no longer maintains this data.

*Updated quarterly.*

**FINDS:** *The Facility Index System.* The EPA's Index of identification numbers associated with a property or facility which the EPA has investigated or has been made aware of in conjunction with various regulatory programs. Each record indicates the EPA office that may have files on the site or facility. Source: Environmental Protection Agency.

*Updated semi-annually.*

**NPL:** *National Priority List.* The EPA's list of confirmed or proposed Superfund sites. Source: Environmental Protection Agency.

*Updated quarterly.*

**RCRIS:** *Resource Conservation and Recovery Information System.* The EPA's database of registered hazardous waste generators and treatment, storage and disposal facilities. Included are RAATS (RCRA Administrative Action Tracking System) and CMEL (Compliance Monitoring & Enforcement List). Source: Environmental Protection Agency.

**RCRA TSD:** *Resource Conservation and Recovery Information System Treatment, Storage, and Disposal Facilities.* The EPA's database of RCRIS sites which treat, store, dispose, or incinerate hazardous waste. This information is also reported in the standard RCRIS detailed data.

### ASTM Databases (continued):

**RCRA COR:** *Resource Conservation and Recovery Information System Corrective Action Sites.* The EPA's database of RCRIS sites with reported corrective action. This information is also reported in the standard RCRIS detailed data.

**RCRA GEN:** *Resource Conservation and Recovery Information System Large and Small Quantity Generators.* The EPA's database of RCRIS sites that create more than 100kg of hazardous waste per month or meet other RCRA requirements. Included are RAATS (RCRA Administrative Action Tracking System) and CMEL (Compliance Monitoring & Enforcement List).

**RCRA NLR:** *Resource Conservation and Recovery Information System sites No Longer Regulated.* The EPA's database of RCRIS sites that create less than 100kg of hazardous waste per month or do not meet other RCRA requirements.

*All RCRA databases are Updated quarterly*

**Environmental FirstSearch  
Federal Databases and Sources**

**Non-ASTM Databases:**

**HMIRS: Hazardous Materials Incident Response System.** This database contains information from the US Department of Transportation regarding materials, packaging, and a description of events for tracked incidents.

*Updated quarterly.*

**NCDB: National Compliance Database.** The National Compliance Data Base System (NCDB) tracks regional compliance and enforcement activity and manages the Pesticides and Toxic Substances Compliance and Enforcement program at a national level. The system tracks all compliance monitoring and enforcement activities from the time an inspector conducts and inspection until the time the inspector closes or the case settles the enforcement action. NCDB is the national repository of the 10 regional and Headquarters FIFRA/TSCA Tracking System (FTTS). Data collected in the regional FTTS is transferred to NCDB to support the need for monitoring national performance of regional programs.

*Updated quarterly*

**NPDES: National Pollution Discharge Elimination System.** The EPA's database of all permitted facilities receiving and discharging effluents. Source: Environmental Protection Agency.

*Updated semi-annually.*

**NRDB: National Radon Database.** The NRDB was created by the EPA to distribute information regarding the EPA/State Residential Radon Surveys and the National Residential Radon Survey. The data is presented by zipcode in Environmental FirstSearch Reports. Source: National Technical Information Service (NTIS)

*Updated Periodically*

**Nuclear:** The Nuclear Regulatory Commission's (NRC) list of permitted nuclear facilities.

*Updated Periodically*

**PADS: PCB Activity Database System**

The EPA's database PCB handlers (generators, transporters, storers and/or disposers) that are required to notify the EPA, the rules being similar to RCRA. This database indicates the type of handler and registration number. Also included is the PCB Transformer Registration Database.

*Updated semi-annually.*

**Receptors:** 1995 TIGER census listing of schools and hospitals that may house individuals deemed sensitive to environmental discharges due to their fragile immune systems.

*Updated Periodically*



**Non-ASTM Databases (continued):**

**RELEASES:** *Air and Surface Water Releases.* A subset of the EPA's ERNS database which have impacted only air or surface water.

*Updated semi-annually.*

**Soils:** This database includes the State Soil Geographic (STATSGO) data for the conterminous United States. It contains information regarding soil characteristics such as water capacity, percent clay, organic material, permeability, thickness of layers, hydrological characteristics, quality of drainage, surface, slope, liquid limit, and the annual frequency of flooding. Source: United States Geographical Survey (USGS).

*Updated quarterly*

**TRIS:** *Toxic Release Inventory System.* The EPA's database of all facilities that have had or may be prone to toxic material releases. Source: Environmental Protection Agency.

*Updated semi-annually.*

## **Environmental FirstSearch Georgia Databases and Sources**

### **GEORGIA SITES LIST (GEORGIA HAZARDOUS SITE INVENTORY)**

The Hazardous Site Inventory (HSI) is a list of sites in Georgia known or suspected of having had a release of a regulated substance above a reportable quantity and which have yet to demonstrate compliance with the most restrictive risk reduction standards in the Rules for Hazardous Site Response. The HSI is compiled and published by the Georgia Environmental Protection Division (EPD).

### **GEORGIA SOLID WASTE FACILITIES (SWF)**

The Solid Waste Facilities List is concerned with the handling of solid waste and includes locations identified with solid waste landfilling or associated activities involving the handling of solid waste. The presence of a site on this list does not necessarily indicate existing environmental contamination but rather the potential. Included in this database are Landfills, Sanitary Landfills, and Construction and Demolition Landfills. Status = 1 means Site is an active site. Status = 2 means Site is a closed site. Status = ID means Site has ceased receiving waste-proceeding with closure requirements.

### **GEORGIA UNDERGROUND STORAGE TANKS (UST)**

The Georgia Rules and Regulations require registration of underground petroleum storage tanks. Inclusion on this list indicates the presence of petroleum storage tanks and therefore the potential for environmental problems. It does not necessarily indicate existing problems.

**Please Note:** The Temp field represents the number of tanks that are listed as Temporarily Out of Use.

### **GEORGIA LEAKING UNDERGROUND STORAGE TANKS (LUST)**

The LUST database is concerned with petroleum storage systems and includes facilities and/or locations that have reported the possible release of contaminants.

### **PUBLIC WATER SUPPLY (PWS)**

The Safe Drinking Water Information System (SDWIS) is a repository of information about Public Water Supplies. This database is a requirement of the Safe Drinking Water Act (SDWA) of 1986 and was previously known as the Federal Reporting Data System (FRDS). The information contained in this database is : Name, Address, Site Identification, Status, and Population Served.

***Environmental FirstSearch***  
***Street Name Report for Streets within .25 Mile(s) of Target Property***

**TARGET SITE:** 12202 APACHE AVE  
SAVANNAH GA 31419

**JOB:** 03-0527.30  
PHASE I ESA

Street Name	Dist/Dir	Street Name	Dist/Dir
Apache Ave	0.01 NE		
Creek St	0.01 NE		
Fulton Rd	0.13 SW		
Middleground Rd	0.25 NE		
State Route 204	0.01 NE		



# Environmental FirstSearch

.25 Mile Radius

ASTM Map: RCRAGEN, ERNS, UST



12202 APACHE AVE, SAVANNAH GA 31419

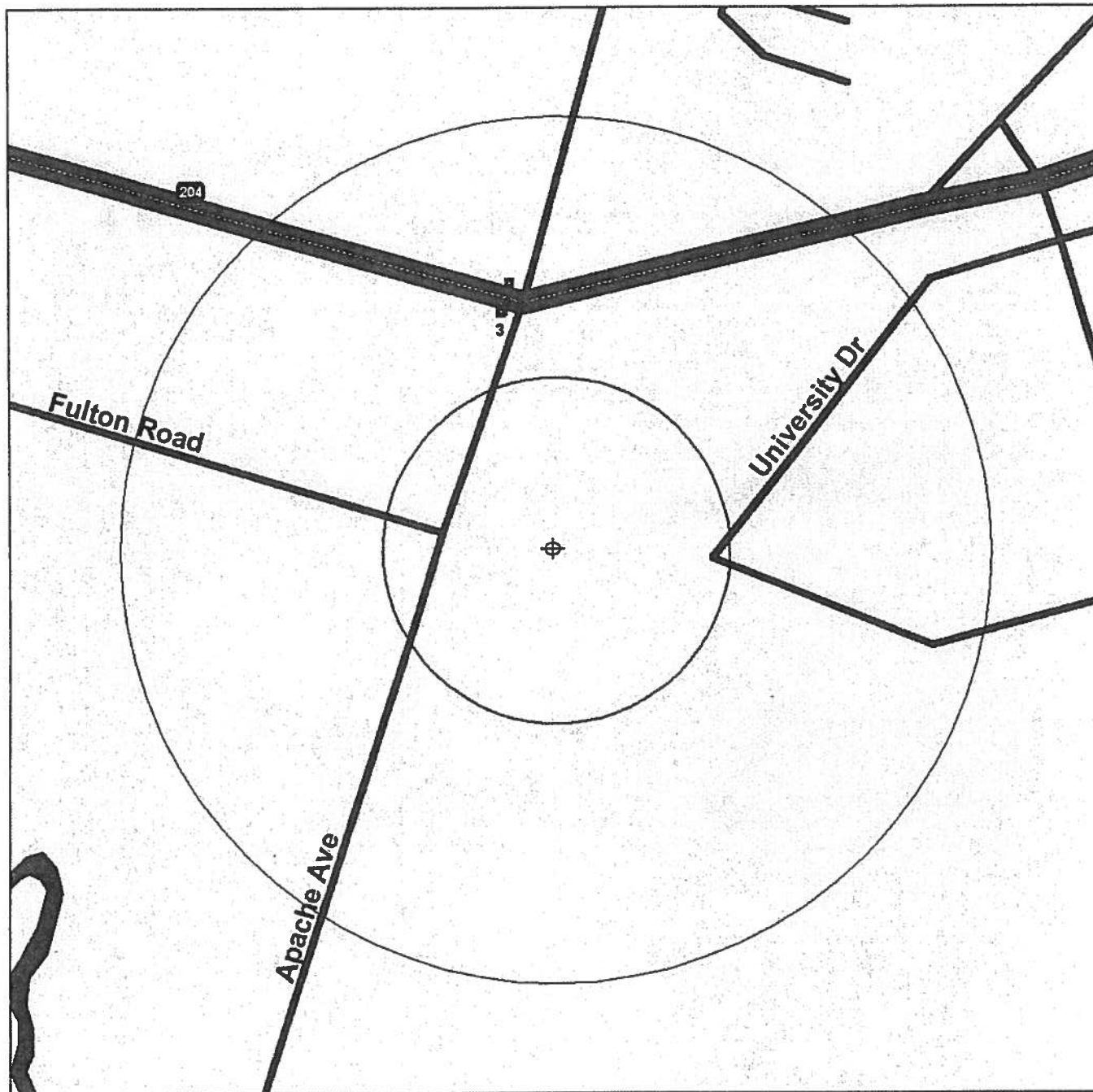

Source: 1999 U.S. Census TIGER Files

Target Site (Latitude: 31.978658 Longitude: -81.168862) .....

Identified Site, Multiple Sites, Receptor .....

NPL, Solid Waste Landfill (SWL) or Hazardous Waste .....

Railroads .....



Black Rings Represent 1/4 Mile Radii; Red Ring Represents 500 ft. Radius



# Environmental FirstSearch

.5 Mile Radius  
ASTM Map: CERCLIS, RCRATSD, LUST, SWL



12202 APACHE AVE, SAVANNAH GA 31419



Source: 1999 U.S. Census TIGER Files

Target Site (Latitude: 31.978658 Longitude: -81.168862) .....

Identified Site, Multiple Sites, Receptor .....

NPL, Solid Waste Landfill (SWL) or Hazardous Waste .....

Railroads .....



Black Rings Represent 1/4 Mile Radii; Red Ring Represents 500 ft. Radius



# Environmental FirstSearch

1 Mile Radius

Selected FEDERAL Selected STATE UST LUST Sites



12202 APACHE AVE, SAVANNAH GA 31419

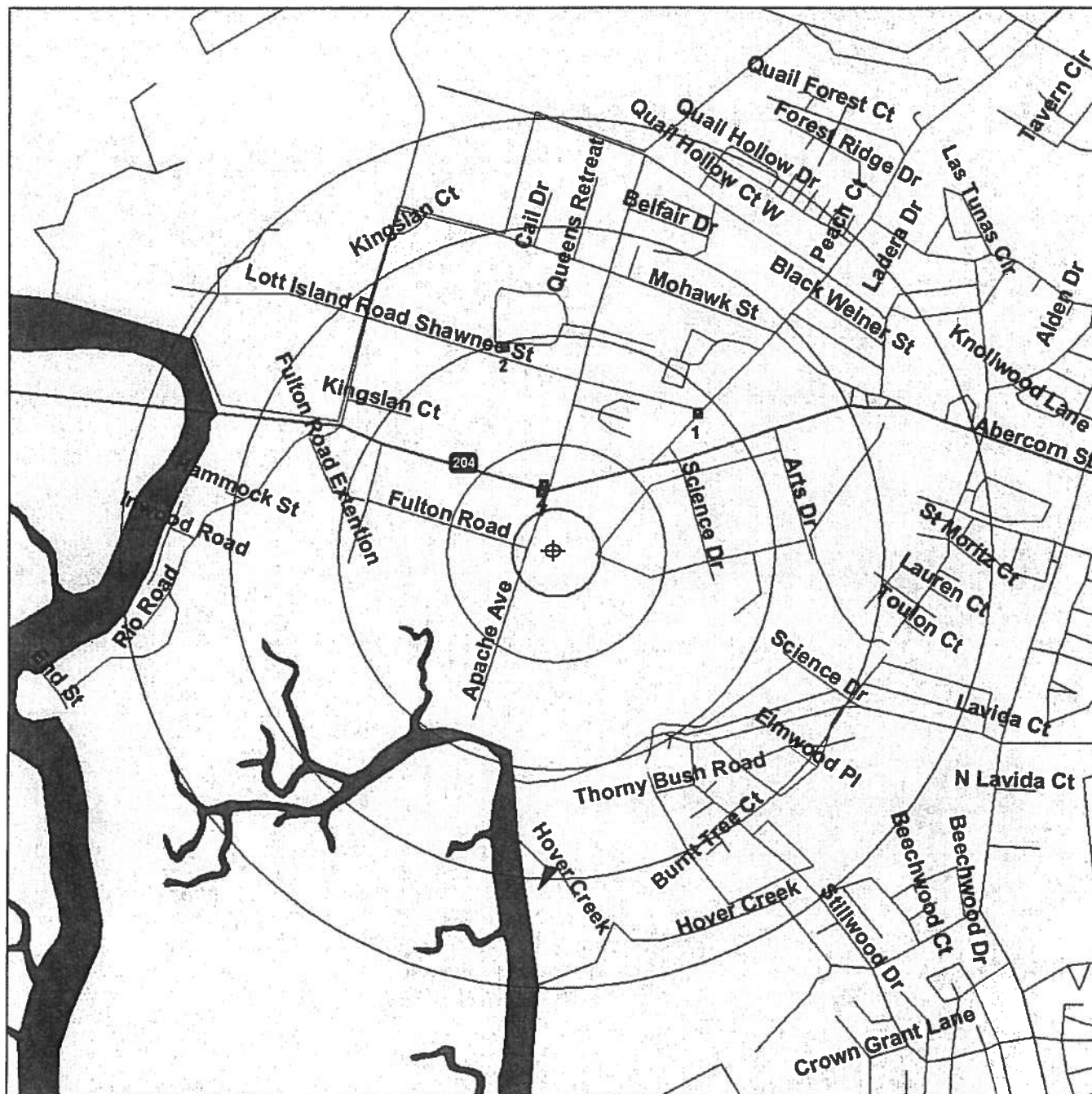

Source: 1999 U.S. Census TIGER Files

Target Site (Latitude: 31.978658 Longitude: -81.168862) .....

Identified Site, Multiple Sites, Receptor .....

NPL, Solid Waste Landfill (SWL) or Hazardous Waste .....

Railroads .....

Black Rings Represent 1/4 Mile Radii; Red Ring Represents 500 ft. Radius





# Environmental FirstSearch

1 Mile Radius  
ASTM Map: NPL, RCRACOR, STATE Sites



12202 APACHE AVE, SAVANNAH GA 31419



Source: 1999 U.S. Census TIGER Files

Target Site (Latitude: 31.978658 Longitude: -81.168862) .....

Identified Site, Multiple Sites, Receptor .....

NPL, Solid Waste Landfill (SWL) or Hazardous Waste .....

Railroads .....

Black Rings Represent 1/4 Mile Radii; Red Ring Represents 500 ft. Radius



## **APPENDIX F**

### **INTERVIEW DOCUMENTATION**



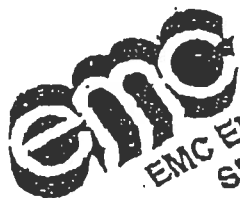

EMC ENGINEERING  
SERVICES, INC.

23 East Charlton Street (31401)  
P.O. Box 3101  
Savannah, Georgia 31412

Phone (912) 222-8533

Fax (912) 222-2920

E-mail - civil@emc-eng.com

• Environmental

• Marine

• Civil

## FAX TRANSMITTAL SHEET

THIS TRANSMISSION CONTAINS      PAGES INCLUDING THIS COVER SHEET

TO: GEORGE BOUCHEA

FROM: DAVID KOSCIUK

FAX: 651-3195

DATE: 10/13/03

EMC PROJECT NO:                     

RE:                     

### IMPORTANT NOTICE

The information contained in this facsimile message is intended only for the use of the addressee listed above. If you are neither the intended recipient nor the employee or agent responsible for delivering the message to the intended recipient, you are hereby notified that any disclosure, copying or distribution of this communication is strictly prohibited. If you have received this communication in error, please notify us immediately by telephone to arrange return of the document to us.

#### NOTE:

- ☐ URGENT - Deliver Immediately
- ☐ Please Call Upon Receipt
- ☐ Attached is the Information We Discussed

- ☐ Please Review and Comment
- ☐ Original to Follow Via Mail
- ☐ Other

REMARKS: THANK YOU





**EMC ENGINEERING  
SERVICES, INC.**

23 East Charlton Street (31401)  
P.O. Box 8101  
Savannah, Georgia 31412

Phone (912) 232-8523  
Fax (912) 232-2920

E-Mail - [civil@emc-eng.com](mailto:civil@emc-eng.com)

- Environmental
- Marine
- Civil

October 13, 2003

Mr. George Bouchea  
Savannah Fire Marshall

Dear Mr. Bouchea:

EMC Engineering Services Inc., is conducting a Phase I ESA on the following properties: 12202 Apache Avenue (Riverside Villa Apartments) & 12208 Apache Avenue (Huggins Property). Please answer the following questions to the best of your knowledge and fax it back to us at (912) 232-2920. Thank you for your time.

Sincerely,

A handwritten signature in black ink, appearing to read "David Kosciuk". The signature is fluid and cursive, with the first name "David" and last name "Kosciuk" clearly visible.

David Kosciuk  
Environmental Technician

1. Are you aware of any environmental concerns (pollution, etc.), past or present, in connection with the property or surrounding properties? YES / NO (If yes, describe below)

Describe \_\_\_\_\_  
\_\_\_\_\_  
\_\_\_\_\_  
\_\_\_\_\_

2. Do you have any knowledge, past or present, of any unreported releases of hazardous substances or petroleum products in connection with the property or surrounding properties? YES / NO (If yes, describe below)

Describe Savannah Mall Area. S.M.E.E. (Cleanup)  
\_\_\_\_\_  
\_\_\_\_\_  
\_\_\_\_\_

3. Do you have any knowledge of waste disposal activities, past or present, in connection with the property or surrounding properties? YES / NO (If yes, describe below)

Describe \_\_\_\_\_  
\_\_\_\_\_  
\_\_\_\_\_  
\_\_\_\_\_

4. Do you recall any emergency response activity, past or present, in connection with the property or surrounding properties? YES / NO (If yes, describe below)

Describe \_\_\_\_\_  
\_\_\_\_\_  
\_\_\_\_\_  
\_\_\_\_\_

5. Do you recall any significant soil removal activity, past or present, in connection with the property or surrounding properties? YES / NO (If yes, describe below)

Describe Sav Mall / Much & Trust / S.M.E.E.  
\_\_\_\_\_  
\_\_\_\_\_  
\_\_\_\_\_

Signature G. Bouchard

Title PFDT

Date 10/14/03

665-0560 cell.



CH/11

## FAX TRANSMITTAL SHEET.

THIS TRANSMISSION CONTAINS 3 PAGES INCLUDING THIS COVER SHEET

FROM: Steve Liotta  
FAX: 353-3234

TO: \_\_\_\_\_  
FROM: David KOSCIUK  
DATE: 10/13/03

EMC PROJECT NO:

RE:

## IMPORTANT NOTICE

The information contained in this facsimile message is intended only for the use of the addressee listed above. If you are neither the intended recipient nor the employee or agent responsible for delivering the message to the intended recipient, you are hereby notified that any disclosure, copying or distribution of this communication is strictly prohibited. If you have received this communication in error, please notify us immediately by telephone to arrange return of the document to us.

NOTE:

- ☐ URGENT - Deliver Immediately  
☐ Please Call Upon Receipt  
☐ Attached is the Information We Discussed

- ☒ Please Review and Comment  
☐ Original to Follow Via Mail.  
☐ Other

REMARKS:

OCT. 13. 2003 5:35PM

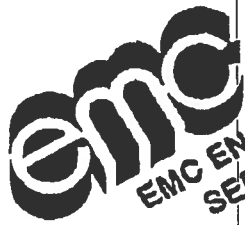

**EMC ENGINEERING  
SERVICES, INC.**

23 East Charlton Street (31401)  
P.O. Box 8101  
Savannah, Georgia 31412

Phone (912) 232-8533  
Fax (912) 232-2920  
E-Mail - [civil@emc-eng.com](mailto:civil@emc-eng.com)

- Environmental
- Marine
- Civil

October 13, 2003

Mr. Steve Liotta  
GA. EPD Coastal District (Savannah)

Dear Mr. Liotta:

EMC Engineering Services Inc., is conducting a Phase I ESA on the following properties: 12202 Apache Avenue (Riverside Villa Apartments) & 12206 Apache Avenue (Huggins Property). Please answer the following questions to the best of your knowledge and fax it back to us at (912) 232-2920. Thank you for your time.

Sincerely,

A handwritten signature in black ink, appearing to read "David Kosciuk". The signature is fluid and cursive, with the first name "David" and last name "Kosciuk" clearly distinguishable.

David Kosciuk  
Environmental Technician

OCT. 13. 2003 5:35PM

NO. 152 P. 3

1. Are you aware of any environmental concerns (pollution, etc.), past or present, in connection with the property or surrounding properties? YES / NO (If yes, describe below)

Describe Anecdotal evidence of a sewage spill 10+ yrs. ago

2. Do you have any knowledge, past or present, of any unreported releases of hazardous substances or petroleum products in connection with the property or surrounding properties? YES / NO (If yes, describe below)

Describe \_\_\_\_\_

3. Do you have any knowledge of waste disposal activities, past or present, in connection with the property or surrounding properties? YES / NO (If yes, describe below)

Describe Open dumping / open burning at property which is

near Belle's Landing restaurant

4. Do you recall any emergency response activity, past or present, in connection with the property or surrounding properties? YES / NO (If yes, describe below)

Describe \_\_\_\_\_

5. Do you recall any significant soil removal activity, past or present, in connection with the property or surrounding properties? YES / NO (If yes, describe below)

Describe \_\_\_\_\_

Signature [Signature]

Title Env. Eng. (EPD)

Date 10/14/03

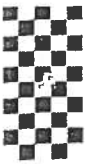

**EMC ENGINEERING  
SERVICES, INC.**

23 East Charlton Street (31401)  
P.O. Box 8101  
Savannah, Georgia 31412

Phone (912) 232-6533  
Fax (912) 232-2920  
E-Mail - [civil@emc-eng.com](mailto:civil@emc-eng.com)

- Environmental
- Marine
- Civil

October 13, 2003

Mr. Vincent Grevemburg  
Chatham County Engineers

Dear Mr. Grevemburg:

EMC Engineering Services Inc., is conducting a Phase I ESA on the following properties: 12202 Apache Avenue (Riverside Villa Apartments) & 12206 Apache Avenue (Huggins Property). Please answer the following questions to the best of your knowledge and fax it back to us at (912) 232-2920. Thank you for your time.

Sincerely,

David Kosciuk  
Environmental Technician

David -  
See attached  
questionnaire as  
requested.  
yJ Grevemburg  
10/16/03

1. Are you aware of any environmental concerns (pollution, etc.), past or present, in connection with the property or surrounding properties? YES / ☒ NO (If yes, describe below)

Describe HOWEVER, WE HAVE AN UN-SUBSTANTIATED  
REPORT OF LANDFILL ACTIVITY LOCATED  
NEAR SOUTH END OF APACHE AVE, NO  
FURTHER INFO WAS PROVIDED

2. Do you have any knowledge, past or present, of any unreported releases of hazardous substances or petroleum products in connection with the property or surrounding properties? YES / ☒ NO (If yes, describe below)

Describe \_\_\_\_\_

3. Do you have any knowledge of waste disposal activities, past or present, in connection with the property or surrounding properties? YES / ☒ NO (If yes, describe below)

Describe (SEE RESPONSE TO #1)

4. Do you recall any emergency response activity, past or present, in connection with the property or surrounding properties? YES / ☒ NO (If yes, describe below)

Describe \_\_\_\_\_

5. Do you recall any significant soil removal activity, past or present, in connection with the property or surrounding properties? YES / ☒ NO (If yes, describe below)

Describe \_\_\_\_\_

Signature Vf Devenberg

Title CIVIL ENGINEER

CHATHAM  
COUNTY

Date 10/16/03





**EMC ENGINEERING  
SERVICES, INC.**

23 East Charlton Street (31401)  
P.O. Box 8101  
Savannah, Georgia 31412

Phone (912) 232-6533

Fax (912) 232-2920

E-Mail - [civil@emc-eng.com](mailto:civil@emc-eng.com)

• Environmental

• Marine

• Civil

October 16, 2003

Ms. Gail Huggins  
606 Salley Brook Road  
Savannah, GA 31419

Re: Huggins Property at 12206 Apache Avenue and Hoover Creek Villas (formerly  
Riverside Villa Apartments) at 12202 Apache Avenue, Savannah, GA 31419  
Environmental Site Assessment (ESA)  
EMC Project No. 03-0527.30

Dear Ms. Huggins:

Here is a copy of the completed ESA questionnaire. Please feel free to call if you have  
any questions or comments. Thank you very much for your time.

Sincerely,

A handwritten signature in black ink, appearing to read "John Patrick". The signature is fluid and cursive.

John Patrick, P.G.  
Project Manager

Attachment

Date 10-16-03

**ASTM Interview**  
**General Interview**

Project Name Huggins Property and Hoover Creek Villas  
Property Description 12206 Apache and 12202 Apache Avenue, respectively, Savannah, GA  
Interviewer John Patrick  
Client Mr. Drew Ernst of HUNTER MACLEAN EXLEY & DUNN, P.C.  
EMC Project No. 03-0527.3

**Purpose & Descriptions**

EMC Engineering Services, Inc. is performing a Phase I Environmental Site Assessment (ESA) per ASTM ASTM Standard E 1527-00 at the above described *property* for the Client. The purpose of the ESA is to identify Recognized Environmental Conditions (RECs) at the site and/or surrounding areas. The purpose of this interview is to obtain information that will help to identify the possibility of *recognized environmental conditions* in connection with the property.

RECs are defined as: " the presence or likely presence of any *hazardous substances* or *petroleum products* on a *property* under conditions that indicate an existing release, a past release, or a material threat of a release of any *hazardous substances* or *petroleum products* into structures on the *property* or into the ground, ground water, or surface water of the *property*. The term includes *hazardous substances* or *petroleum products* even under conditions in compliance with laws."

The quality of answers anticipated are defined as: "The person(s) interviewed should be asked to be as specific as reasonably feasible in answering questions. The person(s) interviewed should be asked to answer in good faith and to the extent of their knowledge.

Date 10-16-03

Time 3:00 pm by telephone

**Person Interviewed:**

Name Ms. Gail Huggins  
Address 606 Salley Brook Road, Savannah, GA 31419  
Phone (912) 925-7702

Relationship to Subject Site Owner of Huggins property at 12206 Apache Avenue  
Duration of Occupancy since 1998

1. Are you aware of any environmental concerns (pollution, etc.), past or present, in connection with the subject property or surrounding properties? YES / NO (If yes, describe below)

Describe Ms. Huggins was told by the seller that a little pond on the property was filled with debris.

2. Do you have any knowledge, past or present, of any unreported releases of hazardous substances or petroleum products in connection with the subject property or surrounding properties? YES / NO (If yes, describe below)

Describe No  
\_\_\_\_\_  
\_\_\_\_\_  
\_\_\_\_\_

3. Do you have any knowledge of waste disposal activities, past or present, in connection with the subject property or surrounding properties? YES / NO (If yes, describe below)

Describe Ms. Huggins hired EMC Engineering Services to prepare a site development plan. During the geotechnical investigation buried debris was found on the site. A subsurface investigation was performed using a backhoe. The buried debris was estimated to cover an area 180 feet x 100 feet and extend down to 12 feet deep.  
\_\_\_\_\_  
\_\_\_\_\_

4. Do you recall any emergency response activity, past or present, in connection with the subject property or surrounding properties? YES / NO (If yes, describe below)

Describe No  
\_\_\_\_\_  
\_\_\_\_\_

5. Do you recall any significant soil removal activity, past or present, in connection with the subject property or surrounding properties? YES / NO (If yes, describe below)

Describe No buried debris was removed from the site.  
\_\_\_\_\_  
\_\_\_\_\_

6. Identify the source of potable water for the subject property, and any knowledge of public or private wells on the property or nearby properties.

City of Savannah  
\_\_\_\_\_  
\_\_\_\_\_

7. Identify the sewage disposal system for the subject property and the age of the system.

The septic system was dug up and removed by Ms. Huggins  
\_\_\_\_\_  
\_\_\_\_\_

8. Identify the means of heating/cooling the buildings on the subject property, including fuel source.

A single family home was demolished and removed from the site by Ms. Huggins. She has no knowledge of how the house was heated or cooled.  
\_\_\_\_\_  
\_\_\_\_\_

9. Do you have any knowledge of any hazardous substances or petroleum products stored on the subject property or surrounding area properties? YES / NO (If yes, describe below)

Describe No  
\_\_\_\_\_  
\_\_\_\_\_  
\_\_\_\_\_  
\_\_\_\_\_

Signature John Petrich  
Date 10-16-03



**EMC ENGINEERING  
SERVICES, INC.**

23 East Charlton Street (31401)  
P.O. Box 8101  
Savannah, Georgia 31412

Phone (912) 232-6533  
Fax (912) 232-2920

E-Mail - [civil@emc-eng.com](mailto:civil@emc-eng.com)

- Environmental
- Marine
- Civil

October 16, 2003

Ms. Patricia R. Glisson  
c/o Real Estate Leasing and Management  
6409 Abercorn, Suite C  
Savannah, GA 31405

Re: Huggins Property at 12206 Apache Avenue and Hoover Creek Villas (formerly  
Riverside Villa Apartments) at 12202 Apache Avenue, Savannah, GA 31419  
Environmental Site Assessment (ESA)  
EMC Project No. 03-0527.30

Dear Ms. Glisson:

Would you please assist me in completing the attached questionnaire for the referenced properties? The people at Real Estate Leasing Management have kindly forwarded this letter on to you. I hope this letter finds you in good health.

I have enclosed a map showing the locations of the properties where we are performing the ESA (Hoover Creek Villas, formerly Riverside Villa Apartments and the Huggins property). Your property is shown (PIN 2-0862-02-001) located across Apache Avenue from the subject sites.

A stamped self-addressed envelope is enclosed for your convenience to return the completed questionnaire. Hand written answers are fine. Please feel free to make a copy of the questionnaire for your record. If you wish I will make a copy and return it to you.

Please feel free to call if you have any questions or comments. Thank you very much for your time.

Sincerely,

A handwritten signature in black ink, appearing to read "John Patrick". The signature is fluid and cursive.

John Patrick, P.G.  
Project Manager

Attachments

Date 10-16-03

**ASTM Interview**  
**General Interview**

Project Name Huggins Property and Hoover Creek Villas  
Property Description 12206 and 12202 Apache Avenue, respectively, Savannah, GA  
Interviewer John Patrick  
Client Mr. Drew Ernst of HUNTER MACLEAN EXLEY & DUNN, P.C.  
EMC Project No. 03-0527.30

**Purpose & Descriptions**

EMC Engineering Services, Inc. is performing a Phase I Environmental Site Assessment (ESA) per ASTM ASTM Standard E 1527-00 at the above described *property* for the Client. The purpose of the ESA is to identify Recognized Environmental Conditions (RECs) at the site and/or surrounding areas. The purpose of this interview is to obtain information that will help to identify the possibility of *recognized environmental conditions* in connection with the property.

RECs are defined as: " the presence or likely presence of any *hazardous substances* or *petroleum products* on a *property* under conditions that indicate an existing release, a past release, or a material threat of a release of any *hazardous substances* or *petroleum products* into structures on the *property* or into the ground, ground water, or surface water of the *property*. The term includes *hazardous substances* or *petroleum products* even under conditions in compliance with laws."

The quality of answers anticipated are defined as: "The person(s) interviewed should be asked to be as specific as reasonably feasible in answering questions. The person(s) interviewed should be asked to answer in good faith and to the extent of their knowledge.

\_\_\_\_\_  
Date \_\_\_\_\_ Time \_\_\_\_\_

Person Interviewed:

Name Ms. Patricia R. Glisson  
Address unknown  
Phone unknown

Relationship to Subject Site Owner of property (1103 Fulton Rd.) across Apache Ave from the subject sites

Duration of Occupancy 1989

1. Are you aware of any environmental concerns (pollution, etc.), past or present, in connection with the subject property or surrounding properties? YES / NO (If yes, describe below)

Describe \_\_\_\_\_  
\_\_\_\_\_  
\_\_\_\_\_  
\_\_\_\_\_

2. Do you have any knowledge, past or present, of any unreported releases of hazardous substances or petroleum products in connection with the subject property or surrounding properties? YES / NO (If yes, describe below)

Describe \_\_\_\_\_  
\_\_\_\_\_  
\_\_\_\_\_  
\_\_\_\_\_

3. Do you have any knowledge of waste disposal activities, past or present, in connection with the subject property or surrounding properties? YES / NO (If yes, describe below)

Describe \_\_\_\_\_  
\_\_\_\_\_  
\_\_\_\_\_  
\_\_\_\_\_

4. Do you recall any emergency response activity, past or present, in connection with the subject property or surrounding properties? YES / NO (If yes, describe below)

Describe \_\_\_\_\_  
\_\_\_\_\_  
\_\_\_\_\_  
\_\_\_\_\_

5. Do you recall any significant soil removal activity, past or present, in connection with the subject property or surrounding properties? YES / NO (If yes, describe below)

Describe \_\_\_\_\_  
\_\_\_\_\_  
\_\_\_\_\_  
\_\_\_\_\_

6. Identify the source of potable water for the subject property, and any knowledge of public or private wells on the property or nearby properties.

\_\_\_\_\_  
\_\_\_\_\_  
\_\_\_\_\_

7. Identify the sewage disposal system for the subject property and the age of the system.

\_\_\_\_\_  
\_\_\_\_\_  
\_\_\_\_\_

8. Identify the means of heating/cooling the buildings on the subject property, including fuel source.

\_\_\_\_\_  
\_\_\_\_\_  
\_\_\_\_\_

9. Do you have any knowledge of any hazardous substances or petroleum products stored on the subject property or surrounding area properties? YES / NO (If yes, describe below)

Describe \_\_\_\_\_  
\_\_\_\_\_  
\_\_\_\_\_  
\_\_\_\_\_  
\_\_\_\_\_

Signature \_\_\_\_\_

Date \_\_\_\_\_



[<<Back to Property Search Results](#)
[Send Map As - Email>>](#)
[Turn Aerial View On](#) | [Zoom to Advanced Viewer](#) | [Print](#) | [Property Card](#)

<b>Owner Name</b>	WILSON-YOUNG RENTALS LLP
<b>Address</b>	APACHE AV 012202
<b>Parcel Number</b>	2-0862 -03-017
<b>Zoning</b>	PUD-M-16
<b>Flood Zone</b>	X500
<b>Aldermanic Code</b>	6
<b>Commissioner Code</b>	6
<b>Zip Code Area</b>	31419
<b>Calculated Acreage</b>	4.083
<b>Land Value</b>	\$0.00
<b>Building Value</b>	\$1,984,500.00
<b>Real-estate Value</b>	\$1,984,500.00

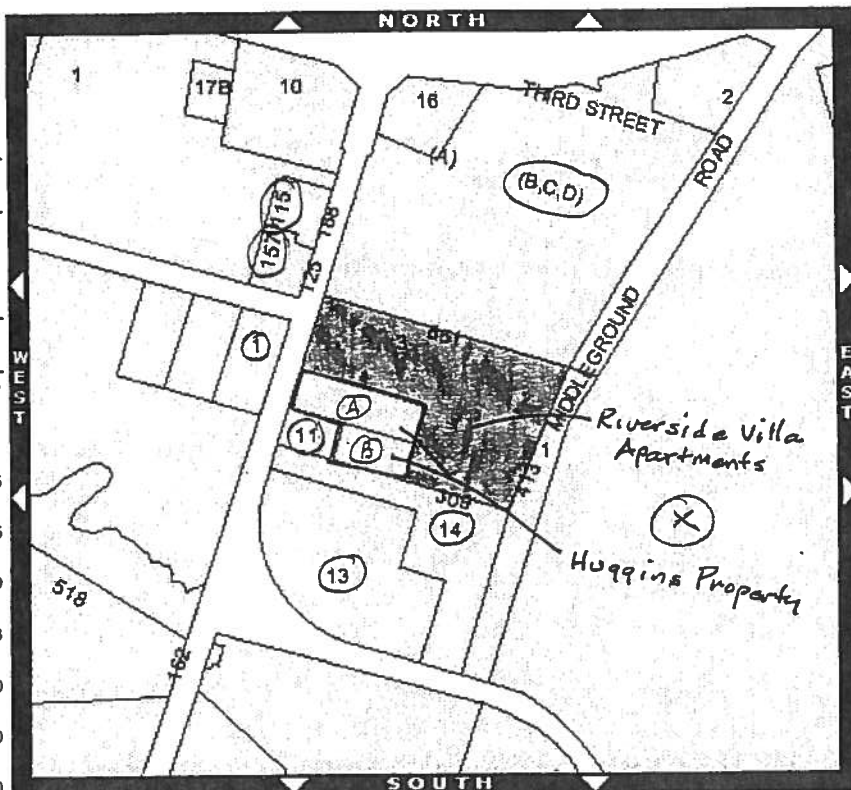
[Zoom In](#) | [Zoom Out](#)

- Ⓐ 2-0862-03-010 Gail J. Huggins  
 Ⓑ 2-0862-03-0118 Gail J. Huggins

- Ⓒ 2-0862-03-017 Wilson Young Rentals, LLP

[HOME](#) | [CONTACT US](#) | [ADVANCED SEARCH](#) | [ADVANCED VIEWER](#)

 Maps by [BinaryBus](#)

- Ⓓ 2-0862-02-001 Patricia R. Glisson  
 Ⓔ 2-0862-03-011 Phyllis Griswold Waters LIT  
 ⒻⒼⒹ 2-0862-03-006 Publix Super Markets  
 Ⓖ 2-0862-03-014 Armstrong Apartments, Ltd.  
 Ⓖ 2-0862-03-013 Armstrong Apartments, Ltd.  
 Ⓖ 2-0862-01-020 Sandra M. Lee  
 Ⓖ 2-0862-01-019 FTB, LLC  
 Ⓖ 2-0781-02-003 Board of Regents of the Univ. Syst. of GA. Armstrong Atlantic Univ

Date 10-15-03

**ASTM Interview**  
**General Interview**

Project Name Hoover Creek Villas  
Property Description 12202 Apache Avenue, Savannah, GA  
Interviewer John Patrick  
Client Mr. Drew Ernst of HUNTER MACLEAN EXLEY & DUNN, P.C.  
EMC Project No. 03-0527.30

**Purpose & Descriptions**

EMC Engineering Services, Inc. is performing a Phase I Environmental Site Assessment (ESA) per ASTM ASTM Standard E 1527-00 at the above described *property* for the Client. The purpose of the ESA is to identify Recognized Environmental Conditions (RECs) at the site and/or surrounding areas. The purpose of this interview is to obtain information that will help to identify the possibility of *recognized environmental conditions* in connection with the property.

RECs are defined as: "the presence or likely presence of any *hazardous substances* or *petroleum products* on a *property* under conditions that indicate an existing release, a past release, or a material threat of a release of any *hazardous substances* or *petroleum products* into structures on the *property* or into the ground, ground water, or surface water of the *property*. The term includes *hazardous substances* or *petroleum products* even under conditions in compliance with laws."

The quality of answers anticipated are defined as: "The person(s) interviewed should be asked to be as specific as reasonably feasible in answering questions. The person(s) interviewed should be asked to answer in good faith and to the extent of their knowledge."

---

Date 10-15-03

Time 10:30 A.M. by telephone

Person Interviewed:

Name Mr. and Mrs. Tetlow  
Address Eagle Development Group, 7370 Hodgson Memorial Drive, Savannah, GA 31419  
Phone (912) 925-9777

Relationship to Subject Site Apartment manager and maintenance of Hoover Creek Villas

Duration of Occupancy since 1999

1. Are you aware of any environmental concerns (pollution, etc.), past or present, in connection with the subject property or surrounding properties? YES / NO (If yes, describe below)

Describe:

---

---

---

---

---

2. Do you have any knowledge, past or present, of any unreported releases of hazardous substances or petroleum products in connection with the subject property or surrounding properties? YES / NO (If yes, describe below)

Describe \_\_\_\_\_

3. Do you have any knowledge of waste disposal activities, past or present, in connection with the subject property or surrounding properties? YES / NO (If yes, describe below)

Describe Served by City of Savannah garbage disposal

4. Do you recall any emergency response activity, past or present, in connection with the subject property or surrounding properties? YES / NO (If yes, describe below)

Describe \_\_\_\_\_

5. Do you recall any significant soil removal activity, past or present, in connection with the subject property or surrounding properties? YES / NO (If yes, describe below)

Describe \_\_\_\_\_

6. Identify the source of potable water for the subject property, and any knowledge of public or private wells on the property or nearby properties.

City of Savannah

7. Identify the sewage disposal system for the subject property and the age of the system.

City of Savannah

8. Identify the means of heating/cooling the buildings on the subject property, including fuel source.

Central Electric

9. Do you have any knowledge of any hazardous substances or petroleum products stored on the subject property or surrounding area properties? YES / NO (If yes, describe below)

Describe One 5-gallon can of paint thinner in the garage

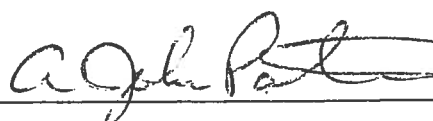
Signature 

Date 10-15-03



**EMC ENGINEERING  
SERVICES, INC.**

23 East Charlton Street (31401)  
P.O. Box 8101  
Savannah, Georgia 31412

Phone (912) 232-6533  
Fax (912) 232-2920

E-Mail - [civil@emc-eng.com](mailto:civil@emc-eng.com)

- Environmental
- Marine
- Civil

October 15, 2003

Ms. Phyllis Griswold Waters  
12210 Apache Avenue  
Savannah, GA 31419

Re: Huggins Property at 12206 Apache Avenue and Hoover Creek Villas (formerly  
Riverside Villa Apartments) at 12202 Apache Avenue, Savannah, GA 31419  
Environmental Site Assessment (ESA)  
EMC Project No. 03-0527.30

Dear Ms. Waters: .

Would you please assist me in completing the attached questionnaire for the referenced properties? I have been unable to contact you at 12210 Apache Avenue. I hope this letter will be forwarded to you and finds you in good health.

I have enclosed a map showing the locations of the properties where we are performing the ESA. Your property is also shown (PIN 2-0862-03-011) located south and adjoining the Huggins property (PIN 2-0862-03-010). A stamped self-addressed envelope is enclosed for your convenience to return the completed questionnaire. Hand written answers are fine. Please feel free to make a copy of the questionnaire for your record. If you wish I will make a copy and return it to you.

Please feel free to call if you have any questions or comments. Thank you very much for your time.

Sincerely,

A handwritten signature in cursive script that reads "John Patrick". The signature is written in black ink.

John Patrick, P.G.  
Project Manager

Attachments

Date 10-15-03

**ASTM Interview**  
**General Interview**

Project Name Huggins Property and Hoover Creek Villas  
Property Description 12206 Apache and 12202 Apache Avenue, respectively, Savannah, GA  
Interviewer John Patrick  
Client Mr. Andrew Ernst of HUNTER MACLEAN EXLEY & DUNN, PC  
EMC Project No. 03-0527.30

**Purpose & Descriptions**

EMC Engineering Services, Inc. is performing a Phase I Environmental Site Assessment (ESA) per ASTM ASTM Standard E 1527-00 at the above described *property* for the Client. The purpose of the ESA is to identify Recognized Environmental Conditions (RECs) at the site and/or surrounding areas. The purpose of this interview is to obtain information that will help to identify the possibility of *recognized environmental conditions* in connection with the property.

RECs are defined as: " the presence or likely presence of any *hazardous substances* or *petroleum products* on a *property* under conditions that indicate an existing release, a past release, or a material threat of a release of any *hazardous substances* or *petroleum products* into structures on the *property* or into the ground, ground water, or surface water of the *property*. The term includes *hazardous substances* or *petroleum products* even under conditions in compliance with laws."

The quality of answers anticipated are defined as: "The person(s) interviewed should be asked to be as specific as reasonably feasible in answering questions. The person(s) interviewed should be asked to answer in good faith and to the extent of their knowledge.

Date \_\_\_\_\_ Time \_\_\_\_\_

**Person Interviewed:**

Name Ms. Phyllis Griswold Waters  
Address 12210 Apache Avenue, Savannah GA 31419  
Phone Unknown

Relationship to Subject Site Owner of property adjoining Huggins property  
Duration of Occupancy Property purchased in 1993

1. Are you aware of any environmental concerns (pollution, etc.), past or present, in connection with the subject property or surrounding properties? YES / NO (If yes, describe below)

Describe \_\_\_\_\_  
\_\_\_\_\_  
\_\_\_\_\_  
\_\_\_\_\_

2. Do you have any knowledge, past or present, of any unreported releases of hazardous substances or petroleum products in connection with the subject property or surrounding properties? YES / NO (If yes, describe below)

Describe \_\_\_\_\_  
\_\_\_\_\_  
\_\_\_\_\_  
\_\_\_\_\_

3. Do you have any knowledge of waste disposal activities, past or present, in connection with the subject property or surrounding properties? YES / NO (If yes, describe below)

Describe \_\_\_\_\_  
\_\_\_\_\_  
\_\_\_\_\_  
\_\_\_\_\_

4. Do you recall any emergency response activity, past or present, in connection with the subject property or surrounding properties? YES / NO (If yes, describe below)

Describe \_\_\_\_\_  
\_\_\_\_\_  
\_\_\_\_\_  
\_\_\_\_\_

5. Do you recall any significant soil removal activity, past or present, in connection with the subject property or surrounding properties? YES / NO (If yes, describe below)

Describe \_\_\_\_\_  
\_\_\_\_\_  
\_\_\_\_\_  
\_\_\_\_\_

6. Identify the source of potable water for the subject property, and any knowledge of public or private wells on the property or nearby properties.

\_\_\_\_\_  
\_\_\_\_\_  
\_\_\_\_\_

7. Identify the sewage disposal system for the subject property and the age of the system.

\_\_\_\_\_  
\_\_\_\_\_  
\_\_\_\_\_

8. Identify the means of heating/cooling the buildings on the subject property, including fuel source.

\_\_\_\_\_  
\_\_\_\_\_  
\_\_\_\_\_

9. Do you have any knowledge of any hazardous substances or petroleum products stored on the subject property or surrounding area properties? YES / NO (If yes, describe below)

Describe \_\_\_\_\_  
\_\_\_\_\_  
\_\_\_\_\_  
\_\_\_\_\_  
\_\_\_\_\_

Signature \_\_\_\_\_

Date \_\_\_\_\_

## **APPENDIX G**

### **LIST OF REFERENCES**



## **LIST OF REFERENCES / SOURCES OF INFORMATION**

- Ms. Densey Louge (Realtor for Ms. Huggins)
- Ms. Gail Huggins (12206 Apache Avenue property owner)
- Mr. Joseph Whitaker (Whitaker Laboratory, Inc.)
- Mr. Drew Ernst (Client)
- Ms. Laura Davis (Accountant for Wilson-Young Rentals, LLP, the owners of the Hoover Creek Villas, 12202 Apache Avenue)
- Mr. Don Tetlow (Maintenance man for Hoover Creek Villas)
- Ms. Paula Tetlow (Apartment manager for Hoover Creek Villas)
- Ms. Andrea Buerkle (EPD UST Management, Atlanta)
- Mr. William Logan (EPD UST Management, Atlanta)
- Mr. Rusty Fredrick (SEPCO)
- Real Estate Leasing Management (Apartment Managers of 1103 Fulton Road)
- Mr. George Bouchea (City of Savannah Principal Fire Marshall)
- Mr. Steve Liotta (EPD, Savannah Office)
- Mr. Vincent Grevemburg (Chatham County Engineers)
- Mr. Chuck Perry (EMC Engineering Services, Inc.)
- Mr. Terry Coleman (Kern Coleman & Company)
- LFR Levine Fricke, Inc., Transaction Screen Process Report Huggins Property Acquisition, May 27, 2003